

Allow us to introduce ourselves

Brief

About us

Scope

Structura Concept's experience brings a depth of knowledge and expertise that goes beyond construction. Whatever the project - large or small - we cover the entire process: from concept, planning permission and design to recognizing and resolving all the complexities of modern construction work - and to dusting off the furniture at the end!

Services

Architectural and construction designers have experience working on facilities of different purposes (functions), experience working abroad, design in prefabricated structures, designing steel structures from concept to realization, detail design and workshop preliminary design.

Values

Structura Concept insists on applying a value-based approach. This has proved its worth time and again, stimulating greater creativity and allowing its integration into the construction process whenever it benefits the interests of all parties in the project. Architectural design has always been challenged by tight budgets – for good reason – but all too often, deadlines and designs tend to serve the interests of construction firms rather than focus on the enduring values of useable space and an agreeable built environment.

Process

Structura Concept's approach is to understand our clients needs and respond to them both efficiently and creatively, searching for any opportunity for improvement at all stages of the process. This close collaboration with the Client results in an organisationally, architecturally and technically sound response to a clarified hierarchy of needs, leading to a construction project with a natural 'feel' and a pleasing expression.

General

Info

Company Name: **STRUCTURA CONCEPT doo**
Location of Headquarter: **Južni bulevar 84, Belgrade**
Website: **www.structuraconcept.com**

Specialities: **Industrial facilities (incl. administrative part), Logistic and warehouses, Commercial/Office buildings, Hotels, design and construction of concrete and steel structures**

Year of Company foundation: **2017 (previously as Studio Structura, from 2010)**
Years of experience: **13**

Number of permanent employees:
Engineers: **74** Administration: **12**

Company experience:
Basic / Preliminary Design
Application Engineering / Design
Construction and Execution Design
Construction Management and Site Supervision Service
General Contractor - unit price based, FIDIC, turn-key contracts

We're a team of makers, thinkers, explorers. We work on projects of all shapes and sizes, but we've earned a reputation implementing turn-key creative solutions on rapid timelines.

Our Pride

Our Team

Management: 6

Designers: 27

Office engineers: 10

On site engineers: 31

Administration: 12

Department

Design



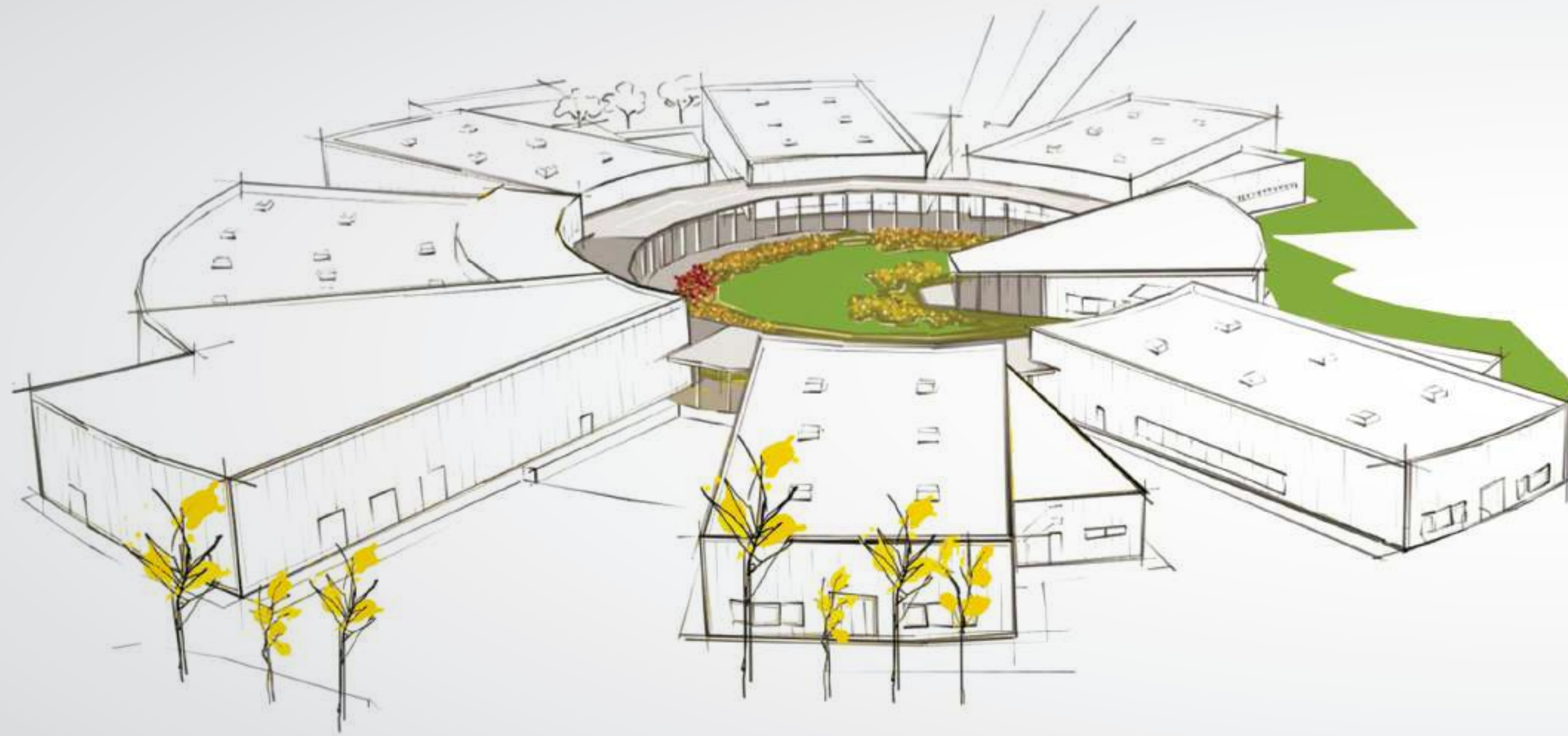

Structura Concept's approach simplifies and brings greater efficiency to the whole process of communication between the various consultants on the project. It prepares the ground for a seamless transition from design to construction. This is further stimulated by bringing in possible contractors as valuable participants in the design process at an early stage, adding a dimension of greater financial security to the design.

In the course of programming and design, our Clients are presented with a realistic vision so that the construction phase becomes the natural next step.

Department

Construction





'Structura Concept' bring a relentless focus to the priorities that each client needs from their construction project. Everything we do is designed to help you realise your investment whether is industrial, residential or commercial property. People are at the heart of our business and everything is focused on doing the best for them and on building lasting relationships. This includes our team, our subcontractors, and most importantly of course - you, the client.

Copyrights

Certificates

ISO 9001 certification of quality management systems
ISO 14001 certification of environmental management
ISO 45001 certification of health & safety management



A certificate that is a prestigious symbol of success and reliability of a company in the market. Apart from the business premises of your company, this internationally recognized brand of business excellence adorns only 3.6% of companies from the region that have managed to achieve and, which is much more difficult, maintain the highest credit ratings in the last three years.



Our company

Locations



Južni bulevar 84, Belgrade, Serbia



Kneza Mislava 14, Zagreb, Croatia



Blvd. Partizanski odredi 15A/1-11, Skopje, North Macedonia

References

Industrial

INDUSTRIAL COMPLEX Sombor
MOTHERSON Čuprija
HUTCHINSON Ruma
CTP GAMMA PHASE I Novi Sad
CTP GAMMA PHASE II Novi Sad
CTP RHO Novi Sad
CTP NVS3 Novi Sad
SIEMENS Kragujevac
SIEMENS II Kragujevac
GORENJE Valjevo
FEKA AUTOMOTIVE Čuprija
PERUTNINA PTUJ Bačka Topola
BLACK&WHITE Zemun
DAG&CO Ruma
LSD Zemun
CAMINADA Subotica
KIA&VOLVO Zemun
FENESTRA Zemun

Hotels

HOTEL 'GRAND' Kopaonik
HOTEL 'MAMULA ISLAND' Montenegro
HOTEL 'SKY' Belgrade
HOTEL 'HYATT' Belgrade
HOTEL 'CENTRAL POINT' Belgrade
HOTEL 'PODRINJE' Banja Koviljača

Interior

'SCAVOLINI' STORE Belgrade
'DROBNI PJESAK' Montenegro
'A1' HEADQUARTERS Belgrade
'UŠĆE' FOODCOURT Belgrade
'ISTRA VILLAS' Istra

Design

CASA MAIAC Kosmaj
FILM COMPLEX Pančevo
OFFICE BUILDING Belgrade
INPUT Zemun
TEHNIX Belgrade

Prefab Structures

HUTCHINSON Ruma
FEKA AUTOMOTIVE Čuprija
BLACK&WHITE Zemun
DAG&CO Ruma
LSD Zemun
CAMINADA Subotica
APPLE LAND Resen, North Macedonia
CERMAT Bitola, North Macedonia

References

Industrial

Industrial Complex



In the world of industrial architecture in our country, you rarely come across surprises: architecture and structures of new and different strength and expression. But when you find yourself in front of one, it immediately grabs your attention with its contrast with the background, a background with which it has nothing in common except its function.

In its unpredictable search for expression, modern architecture can come to solutions that shrug off the basic classical components and approach to design. This is how the industrial complex in Sombor justified this approach in which it was not enough for the architectural form to just follow function. It needed more. There was a need to elevate form into joy and satisfaction. The result was a complex of playful, rhythmic white structures rising from the spacious green carpet of the Pannonian plain. This dynamic set of architectural diversity tells a tale of structural complexity and artistic refinement.

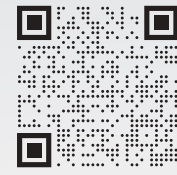
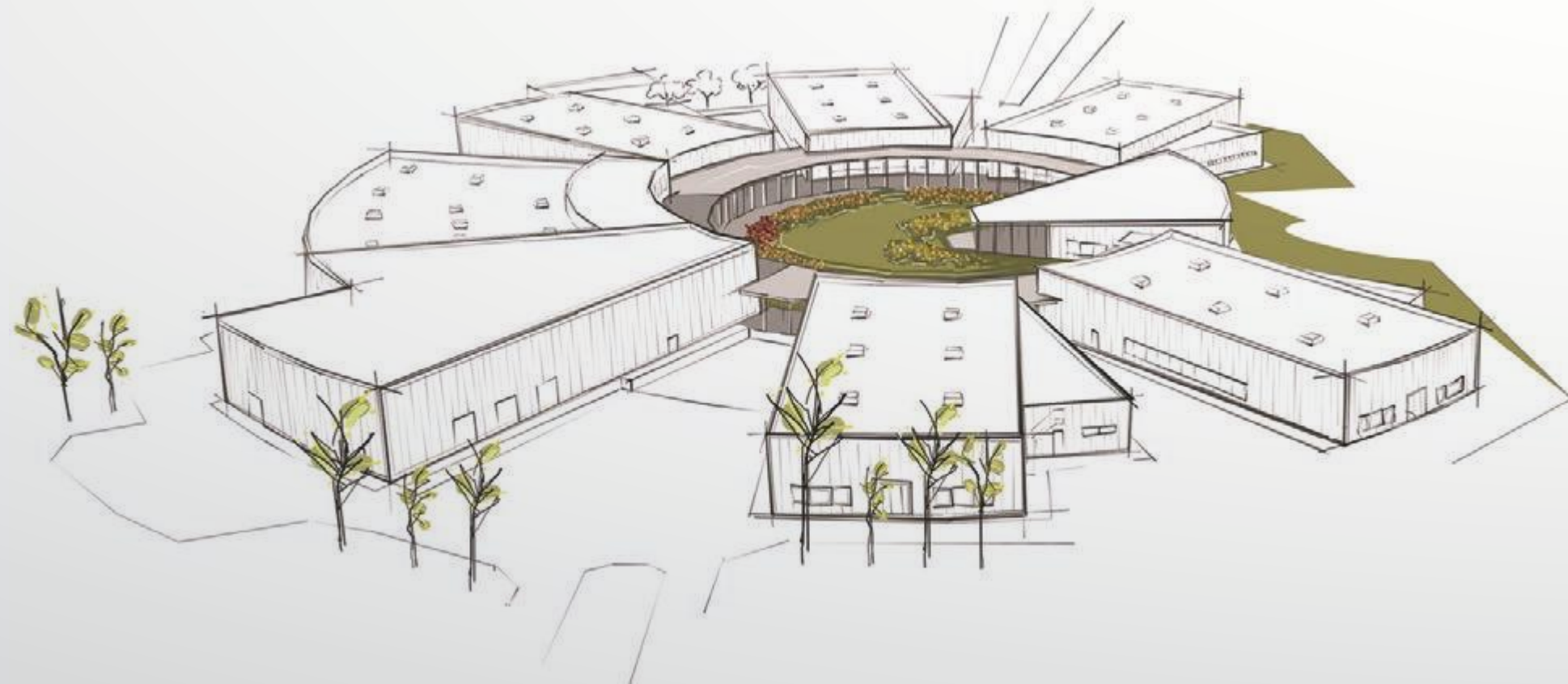

Project task **Design & Construction**
Type of building **Industrial facility**
Project timeline **2022/2023**
Location **Sombor, Serbia**
Area **10000 m²**

The unusual concept of the complex is a product not only of the creator's imagination and constant search for new architectural solutions, but also of solutions to several particularities of the location. Pressed by the limitations of the construction lines and the handicap of a city installation corridor intersecting the site, the designer was looking for a solution that would give the complex the strength to find its place and the vitality to stand the test of time.

Motherson



How can we harmonise modern production technologies and modern construction techniques with traditional principles and values that have been applied over the course of centuries of history? The answer to this question can be found in a new complex for the production of automotive interior parts. Covering some 25,000 m² in the Dobričevo industrial park close to Čuprija, it consists of a production hall with an administrative section and accompanying infrastructure. What makes this building special is the application of the Vaastu principle of design, construction and exploitation. The ancient Vaastu science was created around 5,000 years ago in what today is India. It recognises subtle and powerful influences of nature as an integral part of our immediate surroundings. Vaastu means 'the art of building in harmony with nature'. The Vaastu science and art of protection and healing help to alleviate or neutralize nature's negative influences and to strengthen the positive ones wherever we live and work.



Project task **Design & Construction**
Type of building **Industrial facility**
Project timeline **2020-2021**
Location **Čuprija, Serbia**
Area **23000 m²**

To a casual observer, the building is a typical modern construction designed for industrial production with a concept and expression that suits its purpose. It is formed with straight and 'clean' lines, regular geometric shapes, unremarkable in its colour palette of white and grey. Everything points to recognizable principles of planning and design dedicated to a production process.

Hutchinson



In 2014 we were awarded the contract to develop a new production compound on a site in Ruma, Serbia, for the needs of the Hutchinson group. This was a result of bringing together our efforts to put into practice our 'Design & Build' approach and our Client's trust and willingness to engage in an open-minded and dynamic analysis of the needs of the production process. Uniting of responsibilities of Designer with those of Contractor became very early our strategic goal which we reached, for the first, time in this project. Being given the freedom to analyze the requirements of the program to be designed together with the Client in an open and constructive dialog put us in the position to come as close as we ever did to complete the command of design and construction processes.

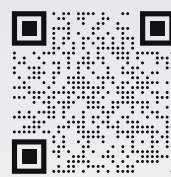

Project task **Design & Construction**
Type of building **Industrial facility**
Project timeline **2014-2019**
Location **Ruma, Serbia**
Area **25000 m²**

Coping with the evolving requirements and opening of new possibilities made us start looking at the potential of prefabrication in general and pre-stressed concrete truss elements in particular. The site as a whole became a testing ground for possibilities of a very reduced number of building elements and procedures practically eliminating the need for detailing.

CTP

ctp

The brand new manufacturing and storage facility of the investor CTP Invest lies in the industrial zone of Novi Sad and covers a surface area of 25,000 m². It consists of business premises arranged in three separate functional units (A1, A2 and B) that can easily be adapted to the needs of future lessees. They all have separate technical rooms, while two of the units also contain office zones. The design and implementation of this premium facility was conducted fully in line with the investor's high standards, resulting in a highly multifunctional space that can easily be adapted to various types of businesses to provide optimum working conditions. Pleasant and safe working spaces were created throughout the building, achieving this feeling through the free entry of daylight and creation of a close visual link to the surrounding landscape.

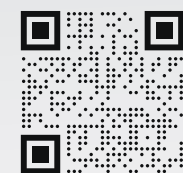

Project task **Design & Construction**
Type of building **Industrial facility**
Project timeline **2018/2019**
Location **Novi Sad, Serbia**
Area **25000 m²**

The entire complex is envisaged to fit naturally into the area - by forming green lawns and belts of tall trees and herbage, simultaneously enriching the space and increasing the atmosphere and environmental value of the location itself.

CTP phase II



The brand new manufacturing and storage facility of the investor CTP Invest lies in the industrial zone of Novi Sad and covers a surface area of 25,000 m². It consists of business premises arranged in three separate functional units (A1, A2 and B) that can easily be adapted to the needs of future lessees. They all have separate technical rooms, while two of the units also contain office zones. The design and implementation of this premium facility was conducted fully in line with the investor's high standards, resulting in a highly multifunctional space that can easily be adapted to various types of businesses to provide optimum working conditions. The entire complex is envisaged to fit naturally into the area - by forming green lawns and belts of tall trees and herbage, simultaneously enriching the space and increasing the atmosphere and environmental value of the location itself.

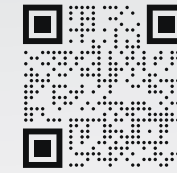

Project task **Design & Reconstruction**
Type of building **Industrial facility**
Project timeline **2019/2020**
Location **Novi Sad, Serbia**
Area **12000 m²**

The design and implementation of this premium facility was conducted fully in line with the investor's high standards, resulting in a highly multifunctional space that can easily be adapted to various types of businesses to provide optimum working conditions.

CTP RHO

ctp

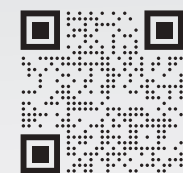

The construction of the manufacturing and business complex in the North IV industrial zone in Novi Sad is exceptionally important for our company, as it represents the continuation of cooperation with an already familiar investor - the company CTP Invest, Serbia. For us, this project is a confirmation that we have justified the trust of investors in previous projects, and we will do our best to ensure that the cooperation is again at a highly professional level. The North IV industrial zone was arranged and adapted for construction in 2016. Since then, 2 large industrial facilities have been built there, one of which is owned by CTP, which is also on our reference list. Due to its excellent position directly connected to the motorway via the E-75, the growth and development of this part of the city is continuing at pace. The manufacturing and business complex is the first phase of building facilities on the site.

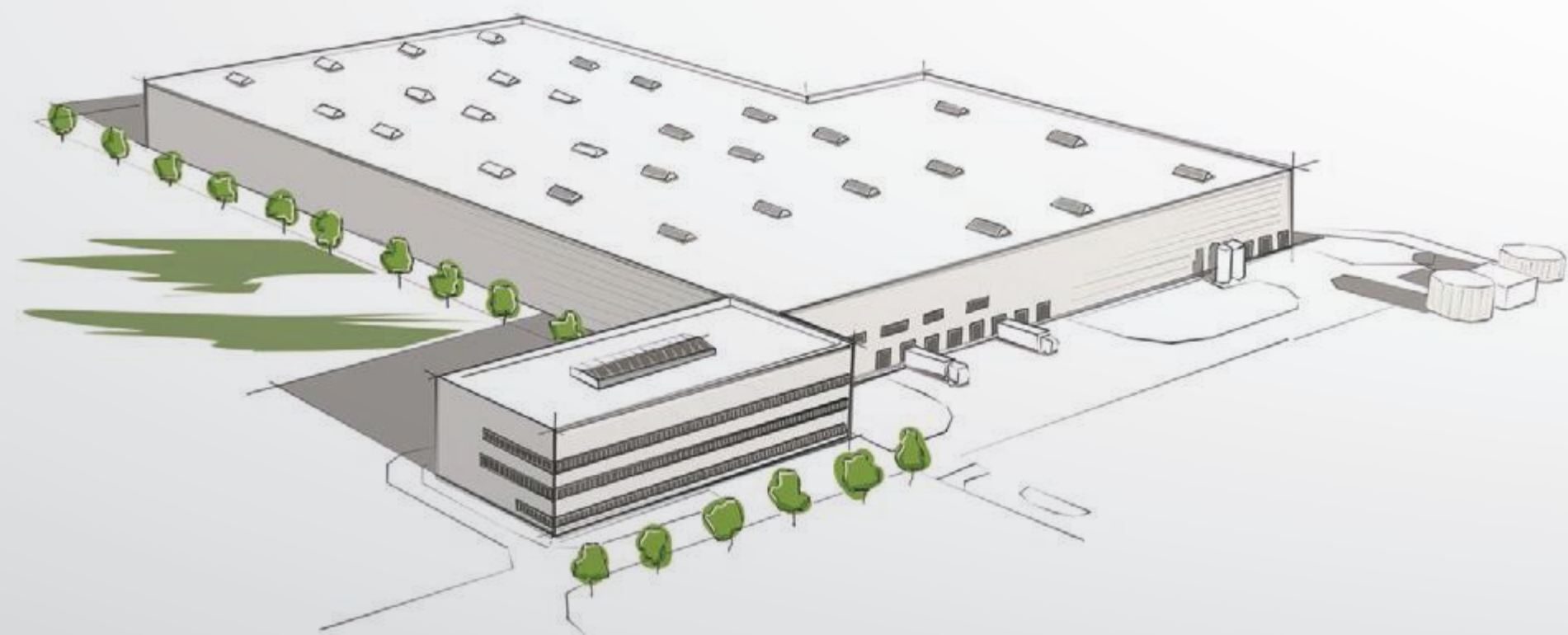

Project task **DFE & Construction**
Type of building **Industrial facility**
Project timeline **2021/2022**
Location **Novi Sad, Serbia**
Area **26765 m²**

In the first phase of the complex a manufacturing section with a warehouse and office block will be built, besides ancillary facilities and an internal road. The total area of the buildings is 26,766m², and the road area is 11,980m². The facilities are designed and constructed for a well-known user, who is engaged in the production of electric motors for the automotive industry.

CTP NS3

ctp

To our great satisfaction, we can present a new project - the construction of facilities in a commercial and manufacturing complex in the North IV industrial zone in Novi Sad. This is the third in a series of complexes that we are building for the same investor – CTP Invest of Serbia. We hope that we shall again justify their trust and meet their expectations in terms of quality and construction deadlines. This project is equally important for all participants, because its construction is slowly sketching the outlines of the planned industrial zone in Novi Sad.



Project task **DFE & Construction**
Type of building **Industrial facility**
Project timeline **2022/2023**
Location **Novi Sad, Serbia**
Area **19000 m²**

The new building works in this city zone are rapidly being followed by new infrastructure, so this site has become one of the most desirable, located as it is near the E-75 motorway with good connections to other cities in the country and region.

Siemens

SIEMENS

A free-standing low-rack warehouse, with a gross construction area of 3,035.98 m², located 1.5 km from city Kragujevac. The primary structure of the building is of prefabricated, reinforced concrete, which, in addition to large roof spans, is characterized by excellent fire-retardant properties. The roof structure is made entirely of prestressed trusses, which span up to 24 m, reducing the number of bearing points inside the building and enabling better use of the interior space.

The building includes an administrative section, with accompanying office and sanitary facilities for 30 workers. Part of the warehouse is served by an internal industrial rail track, whose primary function is to connect the warehouse and the production section of the tram factory. Design of the grounds includes asphalt roadways for heavy traffic, separated from the building and surrounded by green areas.



Project task **Construction**
Type of building **Warehouse**
Project timeline **2020/2021**
Location **Kragujevac, Serbia**
Area **3000 m²**

The newly designed building forms an urban, architectural and functional whole with the existing production and administrative facilities on the factory grounds. The construction work has been organized so as not to affect the functioning of existing facilities and internal traffic infrastructure throughout the period of works, with maximum care for the health and safety of the staff.

Siemens II

SIEMENS

We have been collaborating successfully with our business partner Siemens since 2020. In 2020, we built a warehouse within the already existing complex. Today, in 2022, the cooperation continues. At the request of the investor, a new Business building is in construction process with a parking space and an internal road within the complex. The first phase of construction of the business facility envisages construction of the complete structure of the building, as well as the complete execution of the exterior of the building (facade and roof covering.) The first phase also envisages the complete execution of all interior works on the ground floor and first floor. Business space that will be put to use in the second phase.



Project task **Construction**
Type of building **Business building**
Project timeline **2022/2023**
Location **Kragujevac, Serbia**
Area **2350 m²**

The office building in first phase includes open-plan offices, meeting rooms, management offices, a software testing laboratory, a rack room, men's and women's toilets, telephone booths, a research center, "meet and talk" spaces and "scrum" zones. The second phase envisages interior works on the second floor, which will be organizationally identical to the first floor.



Working with one of our oldest Clients is always an opportunity to test and build upon our understanding of what the needs of a production process are and how they evolve. Having been granted the privilege to design the phase II of Gorenje refrigerator plant in Valjevo (2012), making it the largest such production line in the region, six years later (2018) we were entrusted with designing and building of yet another extension of the capacities to house the line for 'old-timer' models. Out of this project we started developing a new line of competence which we had an opportunity to apply to the benefit of our Client on various projects notably in connection to the move of 'old-timer' production line and the move of refrigerator door production to Serbia in 2018.

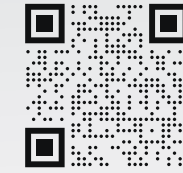

Project task **Design & Project Management**
Type of building **Industrial facility**
Project timeline **Phase I 2012, Phase II 2017**
Location **Valjevo, Serbia**
Area **23500 m²**

When working for a Client who is extremely aware of the constraints of the technology used for production, the project grows naturally from exact sequence of operations and flow of different fluids used in the process either as raw materials such as iso-cyanide and polyol or sources of energy such as, compressed air, steam, electricity or gas required to transform these raw materials into final products.

Feka Automotive



The building has a manufacturing and commercial purpose, designed for the Turkish investor 'Feka Automotive'. The starting point for the design was the need to divide the manufacturing and business sections, where three types of user will be able to move and function without obstacles, but also to develop a special atmosphere for future visitors and clients. For all of these reasons we connected three cubes with different purposes and volumes into a single compact mass. The exterior division was achieved by forming each of the three cubes that make up the compact mass of this facility, with an emphasized entry partition. The openings of the façades were dictated by the volumes of the rooms inside.

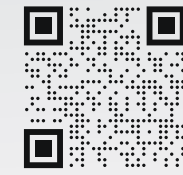

Project task **Design&Construction**
Type of building **Industrial facility**
Project timeline **2018-2019**
Location **Ćuprija, Serbia**
Area **6000 m²**

This facility is of capital importance for the town of Ćuprija, which gave us an additional incentive to be as efficient and accurate as possible in my work. In addition to pre-stressed prefabricated elements, the structure contained a large amount of monolithic concrete, together with a secondary structure of steel profiles, creating an enormous skeleton.

Perutnina Ptuj



The Investor has submitted a request for the design and construction of a modern broiler farm in Backa Topola. The farm is located away from the settlement, but positioned so as to be near a local road to facilitate communication and transport of poultry. Ensuring quality in poultry farming requires compliance with certain basic requirements, primarily regarding quality housing, quality feed and a high degree of hygiene in the facility and the complex itself. In this case the form of the building primarily follows its function and the technology in question, highly demanding in terms of temperature, humidity, ventilation, maintenance of a suitable micro-climate, constant air flow, a high degree of hygiene: all aimed at ensuring the highest quality conditions for raising animals and avoiding animal deaths. The buildings for broilers have rectangular floor plans of 120 x 21 m, with a total area of 2,520 m². They have an assembled steel structure, whose columns are supported by reinforced concrete parapet wall panels, on AB point foundations casting.

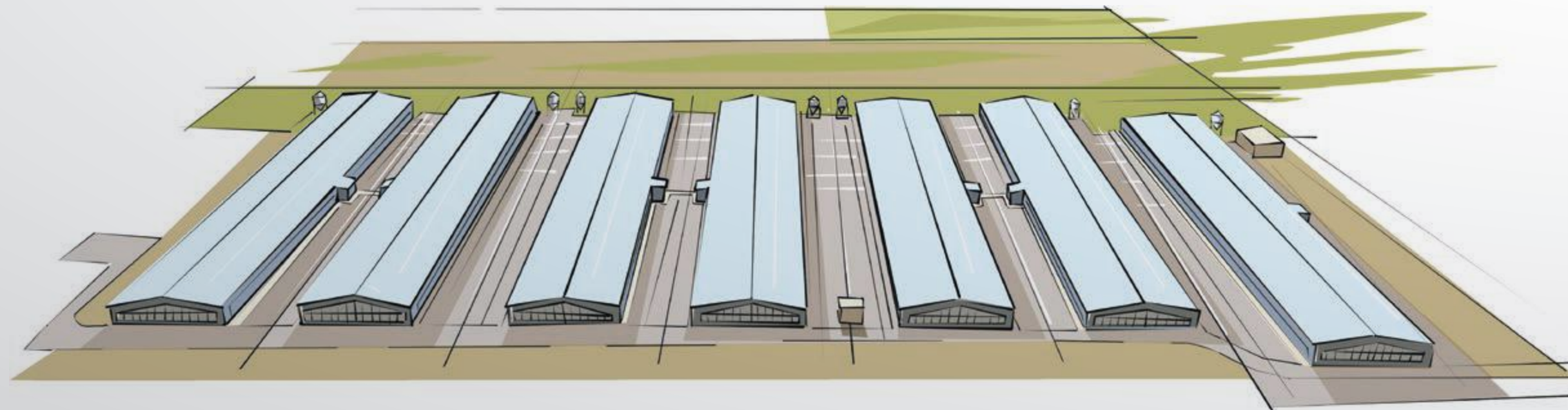
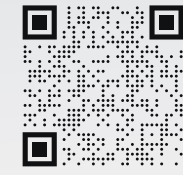

Project task **Design & Construction**
Type of building **Broiler farms**
Project timeline **2019-2023**
Location **Bačka Topola, Serbia**
Area **3 x 17500 m²**

The main roof structure consists of trusses spanning 21m bearing rafters spaced at 2.6m. The longitudinal façade is stabilised with vertical wall braces and the roof with horizontal roof braces. The facades, roof and ceilings consist of thermal insulation panels. An interesting feature and a challenging one to execute was the unreinforced concrete floor slab.

Black and White

Black & White

The building is a manufacturing and commercial facility intended for the production, processing and sewing of textile products. It is located on a site in Zemun's commercial zone, between the Belgrade – Novi Sad highway and an internal road. The facility is positioned so as to have quick and easy access to the Belgrade – Subotica highway, and is well connected with other parts of the city. A wide, flat, green belt separates the building from the road. The building has a gross floor surface of 3,158m² on a site of 4,790m². The administrative section consists of ground + 3 floors, while the manufacturing section is a single-story structure with a gallery extending along the entire circumference of the production line. The inspiration for defining the form and materials stems from the name of the company headquartered in the building - Black and White. The monochromatic palette was chosen to allow a focus on the myriad of patterns and colours of all the materials you see on entering the structure, and that are the very reason for building the facility.

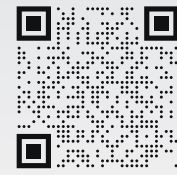
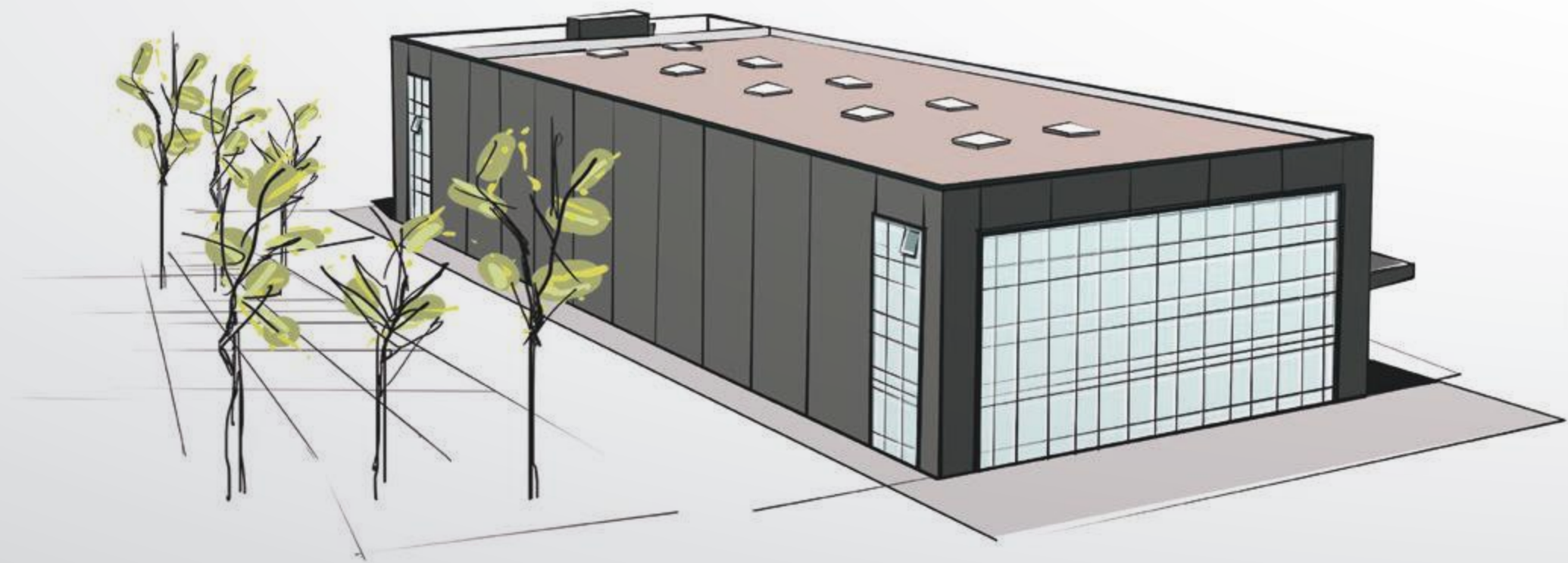

Project task **Design & Construction**
Type of building **Industrial facility**
Project timeline **2019-2020**
Location **Belgrade, Serbia**
Area **2500 m²**

The freestanding structure has a clean, geometric form. The compact and simple form was obtained through the use of black façade panels that are intersected by large transparent surfaces that draw us into the building's interior. The building consists of a prefabricated structure with a facade comprised of panels, providing a cost-effective and efficient modern construction.

Dag and Co



The manufacturing and storage facility DAG-CO is located in the lovely little town of Voganj near Ruma, beside the road towards Sremska Mitrovica. Its location is highly attractive, being accessible and visible from the local road. Due to the rapid growth of the company and the volume of its manufacturing, the investor wanted to build a facility that would meet its needs and unify all phases of the manufacturing process in a single location. The total surface area of this structure therefore covers 4,400 m² and consists of three separate functional units: administrative (towards the road), manufacturing and storage (towards the rear). There is a clear difference between the administrative and manufacturing and storage parts in the finish of the building façades. The administration section contains office space with meeting rooms, a showroom to exhibit products, and a section for the staff. A special request by the investor was for a transparent visual connection between administration and manufacturing, so that the management can always follow production.

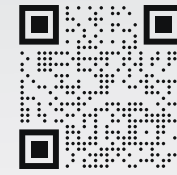

Project task **Design & Construction**
Type of building **Industrial facility**
Project timeline **2018**
Location **Ruma, Serbia**
Area **4400 m²**

The administrative part of the building is carefully oriented partly towards the east but mainly towards the sunny south, forming well-lit and pleasant office spaces. Its exterior is decorated by a particular composition of façade openings, repeated at regular intervals, and a multi-coloured facade bearing the recognizable colours of the investor's logo.

LSD

LSD

This warehouse facility is located in Zemun Polje, developed for the investor Light and Sound Design. The purpose of the building is storage, but in the design process we have made sure the materials and organization of the space are kept flexible, and that it flexibly provides for future adaptation to various purposes. This makes it possible to divide it into several independent units by floor. In its shaping and materials we opted for an industrial appearance, using materials that meet demanding requirements for thermal and acoustic properties.

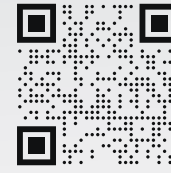

Project task **Design & Construction**
Type of building **Showroom and administration**
Project timeline **2018**
Location **Zemun, Serbia**
Area **3000 m²**

In this spirit, the finish uses shades of grey contrasted with the natural green walls. This visual relationship was chosen to present a basis for different users and their needs for interior movable furnishings.

Caminada



This commercial and manufacturing building in Subotica was designed for the Italian investor Caminada. The investor's request was to focus on manufacturing and communication within the building. We placed a visual emphasis on the main entrance by accentuating its form with an intense red highlight, the trademark colour of the company. We distinguished the commercial and manufacturing sections of the interior using different materials, patterns and colours. The requirement for two tracts of offices towards one façade was met by setting tall transparent glass surfaces along the hallway, and partition walls between the offices. The full doors with a warm wood pattern visually intersect the long glass surface and provide the hallway space with a warmer, more playful atmosphere.

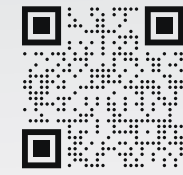

Project task **Design & Construction**
Type of building **Industrial facility**
Project timeline **2017/2018**
Location **Subotica, Serbia**
Area **2400 m²**

This complex, divided into a commercial, production and warehouse section, with its ancillary facilities (power block and two underground tanks) and complex external organization, required the engagement of a high quality workforce and great planning precision.

Kia and Volvo

KIA VOLVO

This business facility consists of two auto-salons and a common business zone located at the gallery level. The task was to form two different spaces that comprise a single unit. In addition to the need to comply with all standards for designing salons for renowned automobile manufacturers, the challenge was also to clearly define a facade that would in itself constitute an advertisement for these two companies. The finish of the façade itself - the colour of the glass and panels - was chosen in accordance with the trademark colours of the automobile brands for which that this modern complex was made. The architectural solution for the new auto-salon of these renowned global car manufacturers in Belgrade presented a number of challenges during construction, particularly in terms of connecting different materials and finishes on the building, different facade elements (glass façade and thermal façade panels) and the interior.

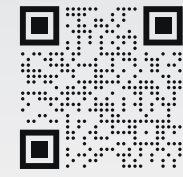

Project task **DFE & Construction**
Type of building **Car retail**
Project timeline **2018/2019**
Location **Belgrade, Serbia**
Area **2100 m²**

The full complexity of the construction manifested itself mainly in the organization of a large number of contractors for finishing works in the interior and the fitting of many different materials and items of equipment, each having a distinct technology of installation.

Fenestra

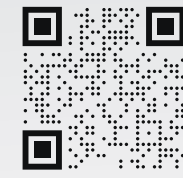

The building was developed for the needs of the investor and in accordance with the construction permit, as a new free-standing facility in the commercial complex near Batajnica. Regarding its function and shape, it consists of two connected units the front office administration area and the rear storage area - a hall. The entire building and its external design were produced as two completely identical but symmetric units with a mirror image division of function and form along transversal and longitudinal directions, all in accordance with the investor's desire to enable the full division of the building for two owners. According to the author's vision, the symmetric division gives this commercial facility a specific character in its shape. The Fenestra business and logistics center was designed as a skeletal system. The investor's requirement that all structural elements be produced on the spot presented a particular challenge, both for the construction deadline and for the quality of the works.

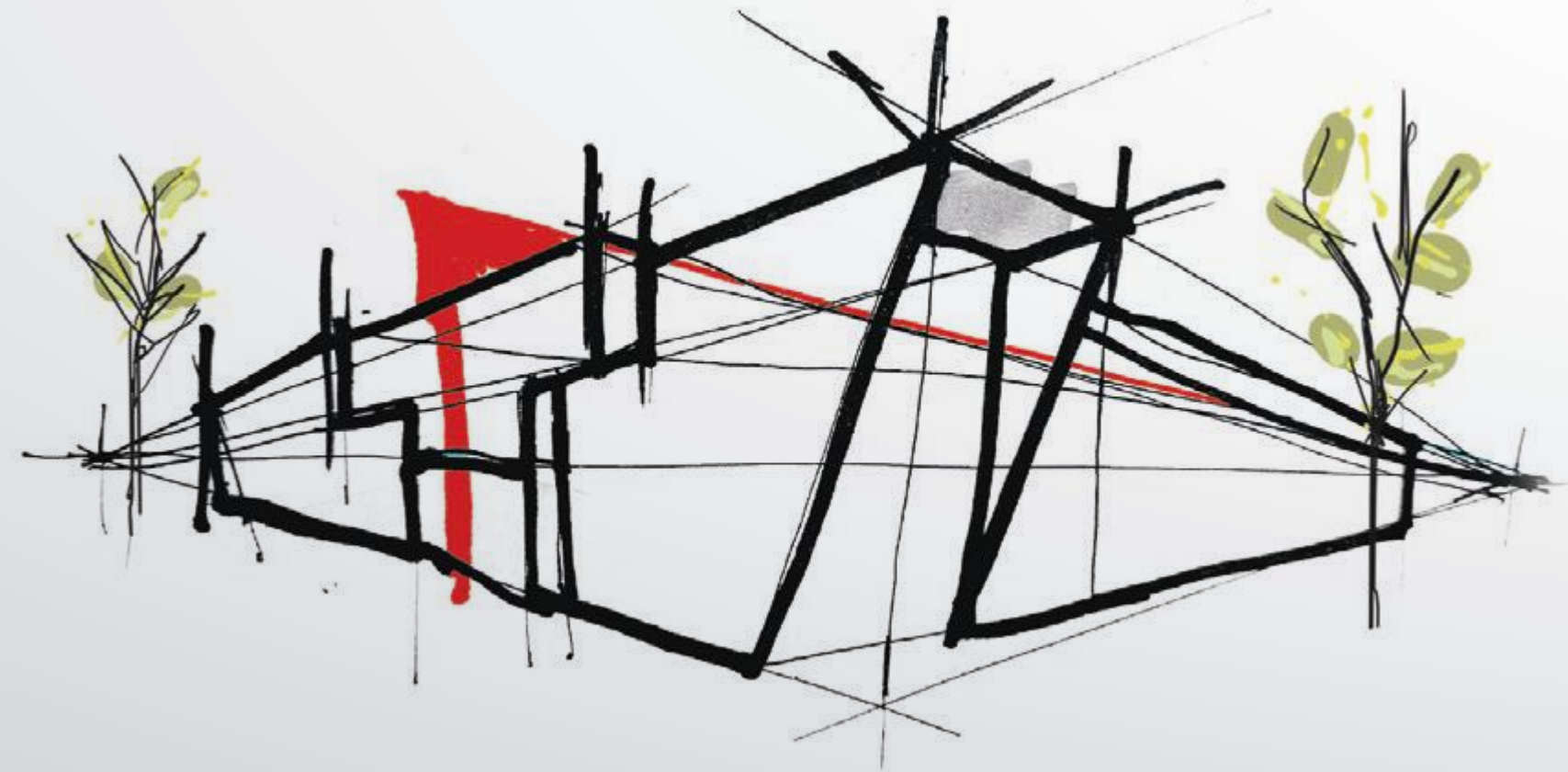

Project task **Construction**
Type of building **Industrial facility**
Project timeline **2016/2017**
Location **Belgrade**
Area **2400m²**

Particular attention was given to the construction of concrete roof supports during the installation of the shuttering, reinforcement, and the pouring of the concrete, due to the complexity of the structure itself, particularly in the administrative part of the building, as well as the difficult working conditions.

References

Hotels

Hotel Grand

MK Mountain Resort

On Kopaonik, in the most beautiful National Park in Serbia, general contractor Structura Concept has renovated and furnished the Grand Hotel. For a period of seven months, our team of civil, HVAC, electro, and interior engineers have worked together to achieve the goal to the highest standards and hand over the hotel. Special emphasis was placed on the entrance - reception, the Lounge BACCO bar, the Garden restaurant, the Boarding House restaurant, the spa and pool area. Everything had to be perfectly in line with the highest world standards. The sophisticated furniture subtly softens the playfulness and sharpness of the finishing elements, and the result of this combination is an elegant and pleasant space to stay in.

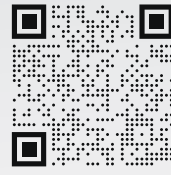

Project task **Reconstruction and furnishing**

Type of building **Hotel**

Project timeline **2021**

Location **Kopaonik, Serbia**

Area **7000 m²**

The interior is further enriched by plant life. Natural materials dominate, with marble, wood and leather both in the paneling and the furniture. 'Grand' hotel vision has been defined by a seamless alignment of cultural and design sensibilities, modern luxury, art and craftsmanship. A lot of work and effort has been invested to make even the smallest detail perfect, to make an outstanding impression.

Mamula Island

Mamula fortress stands proudly at the entrance to the Bay of Kotor, the embodiment of an extremely bold vision that has given it a more dignified presence now than in the past 80 years of abandonment. The fortress has been restored, preserving its historical and cultural heritage while providing it the profile of the only island spa hotel with a museum. The reconstruction was carried out in accordance with the highest standards, preserving the architectural authenticity and natural heritage of the island.

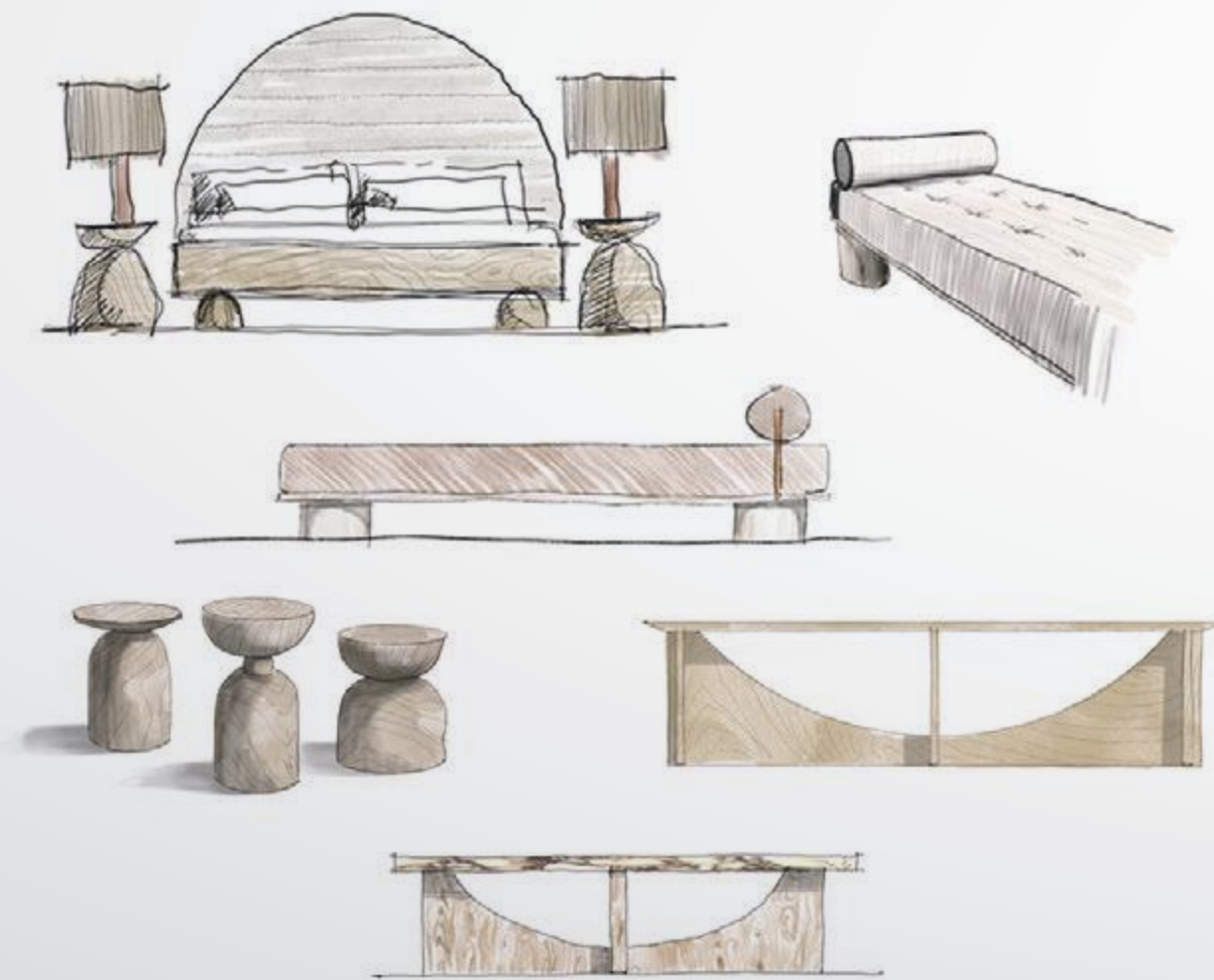
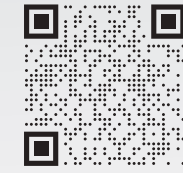

Project task **Furnishing**

Type **Hotel**

Project timeline **2022**

Location **Mamula Island, Montenegro**

Functional schemes and new purposes have been adapted to the geometry of the existing spaces, respecting the atmosphere of the stone walls and vaults. Modest, simple shapes, items of furniture, highlight artisanal details and glorify tradition. The warm shades of oak are present at every step, while the island's paths and passages reveal fresh, infinite views.

Hotel Sky

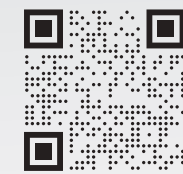

The hotel is located in a peaceful residential zone, not far from the city centre, nestled between traditional urban residential buildings. It consists of five levels, a basement, ground floor and four upper floors. The ground level of the hotel contains the main hall with a reception equipped with modern furniture that, along with the geometric forms permeating the wall, ceiling and floor covers, contributes to the attractiveness and dynamics of this space. The author of the interior of Sky Hotel found inspiration in motifs from nature: the hotel reception was designed as a twisted form, cut through the middle so that the finish of the walls behind it could be glimpsed, and to visually tie together all the elements in this zone.



Project task **Design and furnishing**
Type of building **Hotel**
Project timeline **2019**
Location **Belgrade, Serbia**
Area **2000 m²**

The sophisticated furniture subtly softens the playfulness and sharpness of the finishing elements, and the result of this combination is an elegant and pleasant space to stay in. The interior is further enriched by plant life. Natural materials dominate, with marble, wood and leather both in the paneling and the furniture. The services offered by this hotel include a mini-restaurant with breakfast, a conference room and a mini-spa for moments of relaxation.

Hotel Hyatt

HYATT®

Hyatt Regency Belgrade is hotel for leisure and business travelers, conveniently located in the heart of New Belgrade, the capital's main business and entertainment district, close to the city center and well connected to Belgrade airport. We would especially like to highlight works in restaurant 'Focaccia' in the Hyatt such as demolition and dismantling, dry-assembly works (walls and ceilings), prefabricated partitions, stone-cutting works, floor-laying works, carpentry works, work on plumbing installations, mechanical installations and furnishing. After the reconstruction, the restaurant was named 'Studio'.

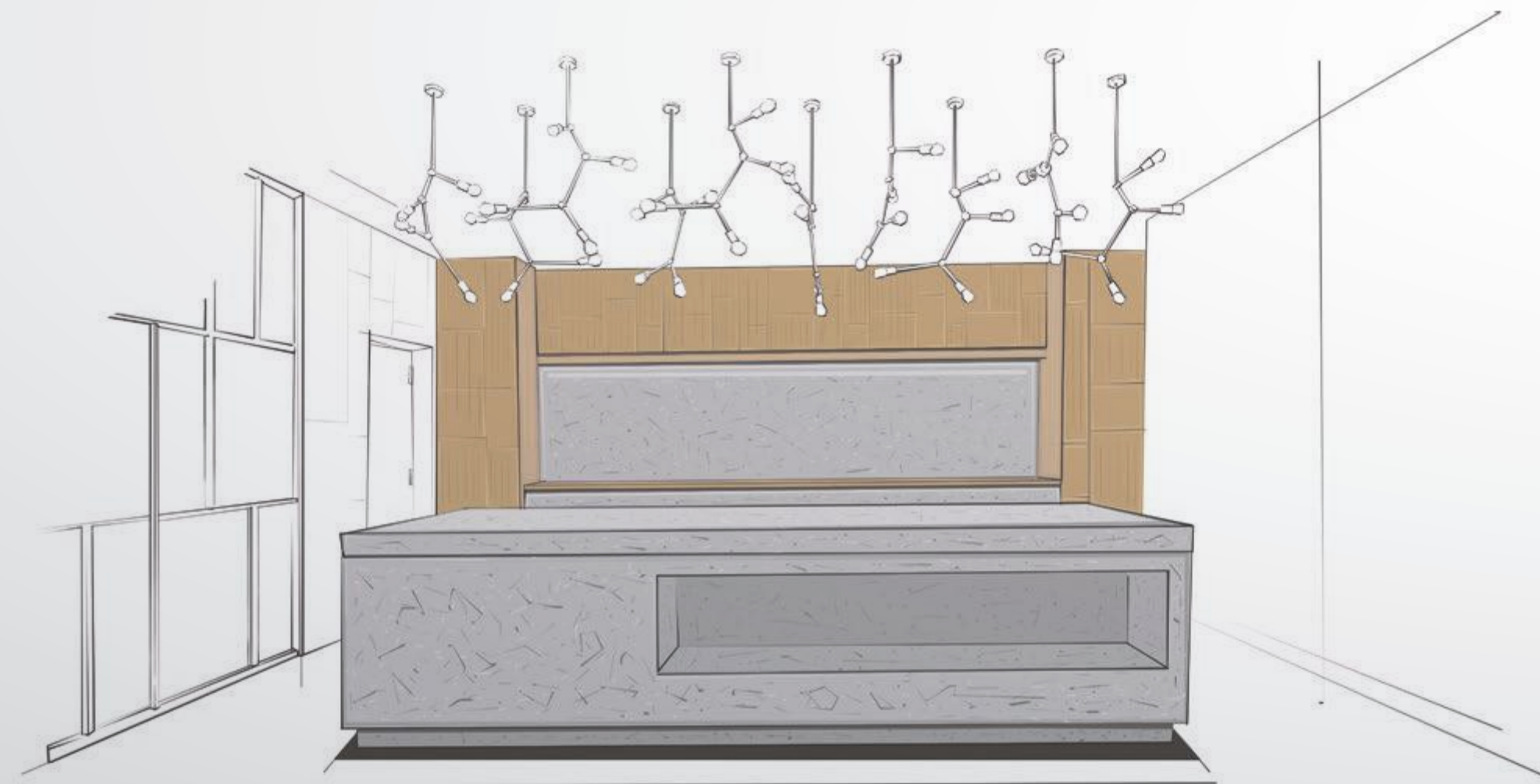
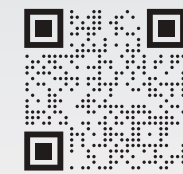

Project task **Reconstruction and furnishing**

Type of building **Hotel**

Project timeline **2019**

Location **Belgrade, Serbia**

Area **437 m²**

Hotel Central Point



In accordance with the main function of bed & breakfast hotel in the central core of the City of Belgrade, the building consists of 2 underground levels of garages with technical and ancillary rooms, a low ground level that provides vehicle and pedestrian access to the hotel from Takovska Street, with the reception and access features of the commercial part of the building, a mezzanine - gallery with a serving kitchen and restaurant and the business area of the building, with another 6 floors and a recessed floor with 57 accommodation units equipped with the latest, high-quality furniture and fittings, for the comfortable accommodation of hotel guests at a 4-star level. Also extraordinary artistic and aesthetic properties and, on the other hand, the stylistic properties of the existing building – all of these together comprise the basic specific features of this building that one first notices.

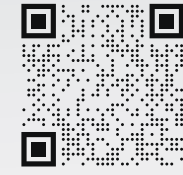

Project task **DFE & Construction**
Type of building **Hotel**
Project timeline **2019/2020**
Location **Belgrade, Serbia**
Area **4200 m²**

The complexity of the function of a hotel, located in the central core of Belgrade, complemented by architectural modelling where the design approach was to connect a modern architectural expression with the use of contemporary materials.

Hotel Podrinje



During its century long existence, the history of „Hotel Podrinje“ was blessed by visits from renown people of their time. King Peter I Karadjordjević, known as the favourite Serbian King among the people, used to arrive by train, reside at nearby Villa Koviljača, strive through the beautiful park and visit Hotel "Podrinje". In memory of the Monarch, near the hotel building stands the SPA bath of King Peter. Nowadays, the park is protected as a natural whole and is in the process of becoming a Park of Nature and Heritage Park that would also include slopes of Mount Gučevo.

The renovated Hotel "Podrinje" will welcome its guests in 43 modern single and double rooms and magnificent apartments located at the first, second, third and attic floor of the building. The guest shall enjoy the indoor pool, summer garden for sunbathing, winter garden with TV lounge, presentation room, children’s playroom, room for babies, restaurant and bar.

This future spa gem will also be ideal for treatments in the Special Hospital Banja Koviljača, located only 200 meters away.

The renovation will consist of full fit out works inclusive of newly installed MEP services. Only high range quality finishing materials will be implemented, with high class furniture and up to date hotel equipment. The exterior and interior design will provide luxury while preserving the touch of history. The whole park and the building itself is considered to be a cultural and historical area; cultural Good "Complex SPA Banja Koviljača" that is under the care of the Regional Authority for Protection of Cultural Heritage and Historic Monuments. Once the current reconstruction is done, the spirit of past times will linger within the building by preserving the complete park facing facade of the hotel from 1910, and incorporated with construction of 1979 to 1982 under the design of Architect Mihajlo Mitrović.

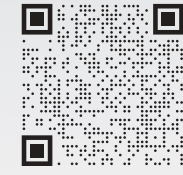

Project task **Reconstruction**
Type of building **Hotel**
Project timeline **2022/2023**
Location **Banja Koviljača, Serbia**
Area **4.850 m²**

The owner “Estate Glory d.o.o.” has appointed “Structura Concept d.o.o.” as the General Contractor to undertake the reconstruction works adopting the design done together by the Design Bureaus “Arhitekt Pro” and ‘Arhikos’.
After the renovation would be completed, the building and the park shall once again embrace within harmony of nature.

References

Interiors

Scavolini store

SCAVOLINI

A free-standing low-rack warehouse, with a gross construction area of 3,035.98 m², located 1.5 km from city Kragujevac. The primary structure of the building is of prefabricated, reinforced concrete, which, in addition to large roof spans, is characterized by excellent fire-retardant properties. The roof structure is made entirely of prestressed trusses, which span up to 24 m, reducing the number of bearing points inside the building and enabling better use of the interior space. The building includes an administrative section, with accompanying office and sanitary facilities for 30 workers. Part of the warehouse is served by an internal industrial rail track, whose primary function is to connect the warehouse and the production section of the tram factory. The sophisticated furniture subtly softens the playfulness and sharpness of the finishing elements, and the result of this combination is an elegant and pleasant space to stay in. The interior is further enriched by plant life.

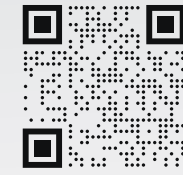
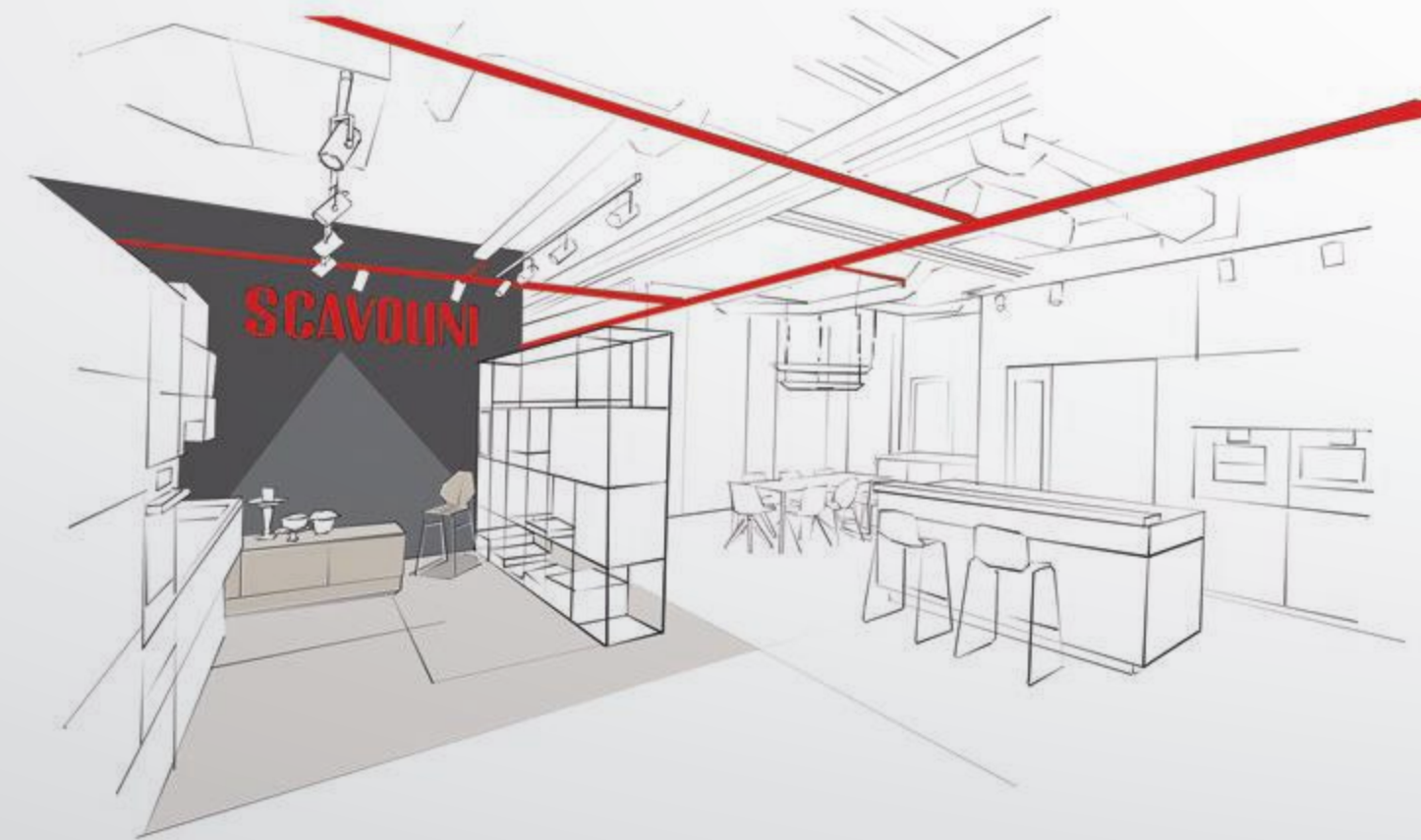

Project task **Design and Reconstruction**
Type **Store and offices**
Project timeline **2019**
Location **Belgrade, Serbia**

Natural materials dominate, with marble, wood and leather both in the paneling and the furniture. 'Grand' hotel vision has been defined by a seamless alignment of cultural and design sensibilities, modern luxury, art and craftsmanship. A lot of work and effort has been invested to make even the smallest detail perfect, to make an outstanding impression.

Drobni Pjesak

The refined marine ambience of this complex provides comfort and fun, offers additional facilities, and complements the impression of its guests' summer vacation with a beautiful view of the sea. The idea was for each of the villas to exhibit elegant interior details, their form and finish associative of those used on luxury ships. The combination of modern furniture with fixed, lavish elements - defined through the walls, floors and ceilings - has made the complex of these villas highly recognizable.

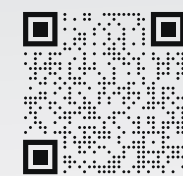

Project task **Design and furnishing**
Type of building **Villas**
Project timeline **2021-2022**
Location **Montenegro**

As for their functionality, each villa consists of four levels, with the first two intended for purposes such as an entertainment room, a mini-bar and living room with a kitchen and dining room, while the other two levels contain relaxation zones: bedrooms and terraces with a view of the garden, the pools of the complex and, of course, the sea.

A1 headquarters

A¹

In the centre of Belgrade, Structura Concept has designed and furnished the whole of the administrative building of A1 (the former VIP Mobile). This was an extremely demanding project in a three-storey building in which furniture was made for a staff of 750 including authentic executive offices, meeting rooms, six kitchens and ancillary rooms on each floor.

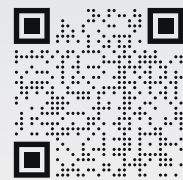

Project task **Design and furnishing**
Type **Headoffice building**
Project timeline **2015**
Location **Belgrade, Serbia**

TC 'Ušće' FoodCourt

MPC

TC "Ušće" is undoubtedly one of the best-known shopping centres in Serbia. Structura Concept designed and equipped the complete FoodCourt on the top floor of a shopping centre with an area of over 550m2. Characteristic for this work is the combination of standard materials and solid wood, which is our specialty in the design and execution of such projects.

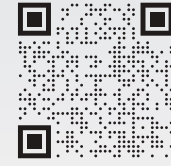

Project task **Design and furnishing**
Type **Food Court**
Project timeline **2015**
Location **Belgrade, Serbia**

Istra Villas

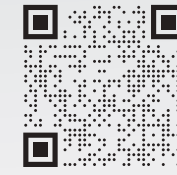

The villas stand on a beautiful hill in the old Istrian town of Vabriga, close to Poreč itself. They are surrounded by the unbelievable nature of the Adriatic climate, close to the sea, in an area suffused by incredible peace and quiet. The area is also distinguished by a large number of bicycle paths, which allow visitors an active holiday in nature.

Four residential units, distributed in three villas. Each unit has a separate entrance to its own yard with a swimming pool and garage, which provides absolute privacy for users. The outer villas, with one residential unit each, have a floor surface of around 450m², while the central villa with two residential units has a total area of some 750m². Designing the interior of these villas was a challenge, but also a pleasure.

Guided by the location, the environment and the perfect harmony of nature, we wanted to bring the same effect to the interiors of the villas. With our design, we wanted to give the users peace and quiet, appropriate repose, and to round off the story that emanated from this wonderful place.



Project task **Design and furnishing**
Type of building **Villas**
Project timeline **2022**
Location **Croatia, Istra**

Warm and natural tones in harmony with furniture of minimalist design are a special feature of these interiors. Bright wall and floor treatments create a calming effect, while the furniture in natural earth tones and wood patterns brings the visitor closer to the outdoor environment in which the complex is immersed.

References

Design

Casa Maiac



In the development of the conceptual design, the idea was to provide a residential oasis near the Kosmaj forest. The spatial organization of the settlement is carefully planned in harmony with the topography of the terrain so that all units are provided with the best views of the natural environment. The architecture of the settlement is dominated by warm earthen tones, which permeate the materials of both houses and surroundings, bringing the spirit of Tuscany to the heart of Kosmaj. The buildings are designed to meet all the needs of modern housing.

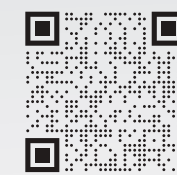

Project task **Design**
Type of building **Villas complex**
Project timeline **2021**
Location **Kosmaj Serbia**

The connection of the interior with nature has been achieved by orienting all the rooms where daily activities take place towards the private gardens with their enchanting views of the natural environment.

Film Complex

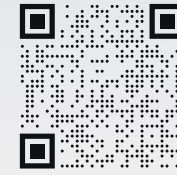

In other words, architecture is coupled with the needs, desires, but most of all the capabilities of the investors. This implies that it depends on facts to a great extent, but its actual field of impact lies in the sphere of meaning. The same is true for the Film Complex project. The initial architectural impulse for providing a solution was developed from the primary need of the film-making establishment for a certain type of space. An economical structure, a functional solution, and a certain artistic expression were pursued... starting from a concept and form predetermined by the investor. The solution was found in a prefabricated skeletal system used to successfully organize the complex: the studio building and workshops. The main facility is a studio building containing three film studios as its nuclei, with the remaining support structures threaded around them. The studios are set up inside the building in a longitudinal row, girdled and interconnected with the ancillary administration rooms.

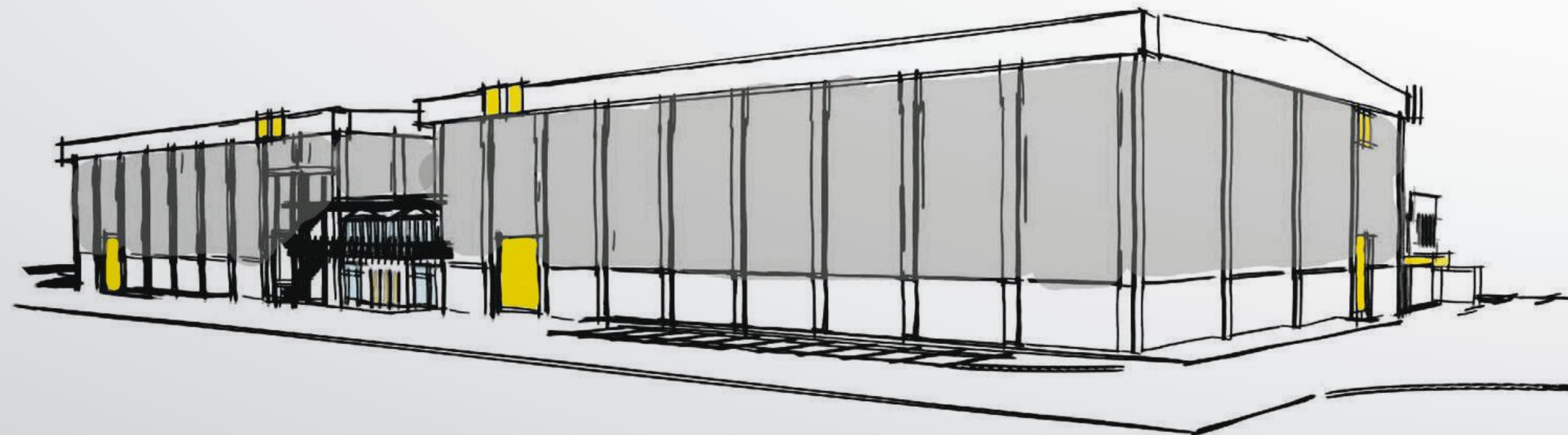

Project task **Design**
Type of building **Film complex**
Project timeline **2019**
Location **Pančevo**
Area **12300 m²**

Following the spirit of functionalism ("Form follows function." - Louis Henry Sullivan), rectangular geometrism, and constructivism, through the composition of rectangular and square elements, with no pretense of high artistic achievement and conditional primarily on the economic aspect, the building reflects and maintains function as its primary quality. The dynamic, commercial content of the film complex is sufficient to infuse the designer with unease and a feeling of responsibility.

Office building

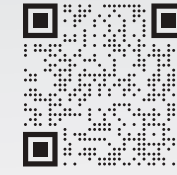

This commercial building with ground floor business facilities is located in a commercial block in Novi Beograd, surrounded by 21st century buildings displaying alternating combinations of glass and aluminium with prominent vertical and horizontal lines. The logic hidden behind the geometry of the glass façade, key to the building's identity, is that the best and most durable architectural works are those inspired by their environment. Thus the form of the building is seemingly simple, while strong, slanted lines that emphasise the volume make the structure dynamic and authentic.



Project task **Design**
Type of building **Office building**
Project timeline **2019**
Location **Novi Beograd, Serbia**
Area **14000 m²**

The materials and the main form of the façade are, in fact, the central characteristics making the building fit well with the integrity of its environment. Its volume is further accentuated by a white aluminium frame, separating the blue from the milky-white glass highlighting the recesses.

Input

INPUT

New development of a commercial-manufacturing facility in the Gornji Zemun commercial zone, along the Belgrade – Novi Sad MP75 main road, in Belgrade, Zemun Polje – for the local investor INPUT of Zemun. The investor's main business is preparing interior elements for retail companies and furnishing commercial spaces with store equipment. The task they set was to design a commercial facility on a site of approximately 8 ha along the Novi Sad – Belgrade main road in Zemun Polje. A manufacturing and warehousing hall is designed with maximum size for the primary needs of the investor, to be built in two phases. Since the investor is in need of office space for their own administration – a management with working areas for economists, salespeople and designers – the design envisages an office annex with a specific shape and visual character, differing from the rest of the structure and providing the building with an authentic and striking architectural look. Other is the manufacturing and storage sections with only a ground floor (central position, four-sided orientation with the longer side in the northwest-southeast direction).

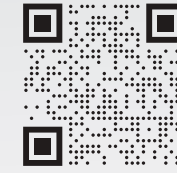

Project task **Design**

Type of building **Industrial facility**

Project timeline **2019**

Location **Zemun, Serbia**

Area **4000 m²**

The structure was planned to be built in phases, with phase II leaning against the phase I manufacturing and storage unit with only a ground floor. The building had to be designed to provide a maximum size on the site, while positioning the free and green areas to support the functionality and the concept of movement of visitor and staff vehicles and servicing by public service and goods vehicles.

Tehnix



A multi-storey commercial building – a new formative and spatial contribution to Peke Dapcevic Street – was designed in the architectural milieu of the industrial zone and the complex in Kumodraz, its background consisting of a moulded iconography interspersed with sporadic folkloric elements. From a functional standpoint, it is organically and structurally connected to the existing main building on the site, emerging from a need to engage with the existing development potential of the site and raise it towards a new commercial and spatial value. Under the conditions of the saturated tissue of the site and the limiting parabola of the structural line, the building finds space through a vertical escape, resting against the existing, yet never completed underground garage. This design finally completes and activates the garage through new functionality – it becomes a warehouse, with the bulk of the new wing of the commercial facility rising above it. The Miesian architectural simplicity and geometrism put the glass membrane, interspersed with a metallic raster lattice, at the core of the artistic experience.

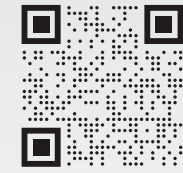

Project task **Design**
Type of building **Office building**
Project timeline **2019**
Location **Belgrade, Serbia**
Area **3000 m²**

With the discrete chromatic key of the membrane itself, incorporating the recognisable tradema colour of the investor's company, the building blends into a single organic unit with the existing main building. At the same time, the playful syncopating rhythm of the raster grid, the openings, and the interplay of full and glazed areas places the building in a counterpoint with its simple environment and imposes itself as the dominant point of the entire artistic view of the complex.

References

Prefab Structures

Hutchinson



The subject of this project is the design of industrial facility - a factory for the production of water pipes under low pressure of the "HUTCHINSON" company in Ruma - Phase 2.

There are three technological units within the building:

1. Administrative block
2. Production block
3. Logistics

The constructive system of the newly projected facility is divided into two constructive units connected by the row of columns. Both units are of a skeletal constructive system that consists of longitudinal and transverse AB frames. The construction of the facility is precast reinforced concrete, composed of prefabricated elements: AB adhesionly prestressed purlins "T" section.



Project task **Design & Construction**

Type of building **Industrial facility**

Project timeline **2014-2019**

Location **Ruma, Serbia**

Area **25000 m²**

Feka Automotive



The subject of this project is the design of a production and storage facility in Čuprija. The facility is being built for the needs of the 'FEKA Automotive' company. The facility is intended for production and storage.

The newly designed building has a rectangular base with dimensions of 100.0x64.00m. The height of the building in the ridge is $h=12$,

The structural system of the newly designed hall is a reinforced concrete frame system in both directions, consisting of AB pillars and AB roof supports. Transverse frames (AB prestressed trussed main girders and AB columns) and longitudinal frames (AB columns and secondary AB girders – full cross section purlins).



Project task **Design & Construction**
Type of building **Industrial facility**
Project timeline **2018-2019**
Location **Čuprija, Serbia**
Area **6000 m²**

The construction of the building is precast reinforced concrete. The AB construction is composed of prefabricated elements: AB prefabricated columns with a cross section of 50x50 and a height of 10.00 to the main support.

Black and White

Black & White

The subject of this project is the design of a construction project for a business-production facility, which is located on the cadastral parcel 1589 C.M. Zemun Polje in Belgrade, for the needs of Black&White company from Belgrade. One part of the building is intended for business premises and the other larger part for production. The object has a rectangular base with dimensions of 62.0x27.0. The height of the building is h=14,00m.

The structural system of the production part of the building consists of transverse and longitudinal reinforced concrete frames.

The transverse direction consists of the AB trussed roof main support of span L=27,0 m, a static simple beam system that rests on the ends of the facade reinforced concrete precast columns.



Project task **Design & Construction**

Type of building **Industrial facility**

Project timeline **2019-2020**

Location **Belgrade, Serbia**

Area **2500 m²**

The structural system of the business part of the building consists of transverse reinforced concrete frames that, together with the mezzanine structure, transfer the load to the AB columns. Horizontal influences are received by the AB staircase core. The constructive system of the mezzanine structure consists of the AB mounting beam of the static simple beam system.

Dag and Co



The subject of this project is the design of a production and storage facility in Voganj, Ruma. The facility is being built for the needs of the 'DAG CO' company. The facility is intended for production and storage. The newly designed building has a rectangular base with dimensions of 87,0x36,20 or 87,0x18,20 m.

The structural system of the newly designed AB hall consists of longitudinal frames (purlins and AB columns) and transverse frames (main trussed supports and AB columns). The horizontal roof structure consists of secondary supports - purlins that rest on the main trussed supports, and they further lean over AB columns on single foundations.

The construction of the facility is precast reinforced concrete, composed of prefabricated elements: AB adhesionly prestressed purlins "T" cross-section span $L_1=13,0\text{m}$ total height $h=69\text{cm}$.



Project task **Design & Construction**

Type of building **Industrial facility**

Project timeline **2018**

Location **Ruma, Serbia**

Area **4000 m²**

The subject of this project is the design of a construction project for a warehouse facility, located in Zemun Polje, for the needs of Light and Sound Design company from Belgrade. The building is divided into two units, one part of the building is intended for business space and the other larger part for storage.

The structural system of the storage part of the building consists of transverse and longitudinal reinforced concrete frames. The transverse direction consists of the AB trussed roof main support 'A' with a span of $L=30,00$ m, a static simple beam system that rests on the ends of the facade reinforced concrete precast columns.

The construction of the building is precast reinforced concrete. The assembly structure is composed of prefabricated elements: AB adhesively prestressed main trussed supports of span $L=30,0$ m, axle height $h=200,0$ cm and width $b=35,0$ cm.



Project task **Design & Construction**

Type of building **Showroom and administration**

Project timeline **2018**

Location **Zemun, Serbia**

Area **3000 m²**

Caminada



The subject of this project is the design of an industrial assembly hall intended for production and for the needs of the Caminada company. The place of construction is Subotica. The building has a rectangular base with dimensions of 90x24m, clear height of 7.5 m.

The structural system is frame-based, which consists of a transverse frame with two AB columns of cross section of 60x50 and 50x50 cm and the main trussed concrete support with a span of 24.0m.

The supporting system of the transverse frame consists of prefabricated reinforced concrete columns with dimensions of 60x50 and 50x50 cm in a 10m grid. An AB cup is left on the top of the columns, which is monolithic and thus connects the roof supports. In the administrative part, there are internal pillars with a cross section of 40x40 cm.



Project task **Design & Construction**

Type of building **Industrial facility**

Project timeline **2017/2018**

Location **Subotica, Serbia**

Area **2400 m²**

Apple Land

The subject of this project is the design of an industrial facility - cold storage (Sector_1) for the storage of apples within the company 'Apple Land' in Resen, Macedonia.

The newly designed building has a rectangular base with dimensions of 68.0x40.8. The height of the building is variable and ranges from h=12.54 m to 15.05 m.

The structural system of the new hall consists of transverse and longitudinal frames.

The transverse direction consists of the AB trussed main beam on three fields of span 14.20+5.60+14.20m in one nave of the hall and likewise (symmetrically) further on the other nave of the hall, which rests on seven columns.

The construction of the facility is precast reinforced concrete, composed of prefabricated elements: AB adhesively prestressed purlins of span L=13,6m, axle height h=80cm and width b=20cm



Project task **Design & Construction**

Type of building **Industrial facility**

Project timeline **2015**

Location **Resen, North Macedonia**

Area **6500 m²**

Cermat

The subject matter of this project is the design of an industrial facility - a refrigerator for the needs of the company CERMAT from Bitola in Macedonia.

The facility is being built within the area of the company Ceramat in Bitola. The facility is intended for a refrigerator. The newly designed facility has a rectangular base with dimensions 70.2x58.0 m. The height of the facility is variable and ranges from $h=12.40$ m to 13.00 m. The total area of the space under the roof is $P=6374.8$ m².

The facility has a ground floor, and a gallery on the smaller part.

The structural system of the newly designed AB hall consists of longitudinal frames (purlins - lattice beams and columns) and transverse frames (main lattice girders and columns). The horizontal roof structure consists of secondary girders – lattice purlins that rest on the main lattice girders, which continue on AB columns on pad foundations.

The structure of the facility is a prefabricated reinforced concrete structure, and it consists of prefabricated elements: AB adhesive prestressed “T” purlins with spans $L=6.50$ m with a total height $h=69$ cm, AB adhesive prestressed lattice purlins with span $L=19.50$ m, axis height $h=120$ cm and width $b=25$ cm, and $L=16.80$ m axis height $h=120$ cm and width $b=25$ cm



Project task **Design & Construction**

Type of building **Industrial facility**

Project timeline **2016**

Location **Bitola, North Macedonia**

Area **6300 m²**

Our respectful

Clients





www.structuraconcept.com
office@structuraconcept.com

BELGRADE, Serbia

Južni bulevar 84/23

NOVI SAD, Serbia

Cara Dušana 32

SKOPJE, North Macedonia

Blvd. Partizanski Odredi 15A/1-11

ZAGREB, Croatia

Kneza Mislava 14

