

Interiors 2024

Brief

About us

Services

We're a team of makers, thinkers, explorers. We work on projects of all shapes and sizes, but we've earned a reputation implementing turn-key creative solutions on rapid timelines. Structura Concept's experience brings a depth of knowledge and expertise that goes beyond construction. Whatever the project - large or small - we cover the entire process: from concept, planning permission and design to recognizing and resolving all the complexities of modern construction work - and to dusting off the furniture at the end!

Furnishing

Structura Concept is specialises in the design, production and installation of complete interiors for hotels, public (office) and residential spaces. We have tested lines of both standard and custom-made furniture, fitted and loose. All types are available, upholstery, panel and solid wood furnishings. We are especially proud of our ability to combine traditional handcrafted manufacturing with modern technology, creating unique products with dedicated functionality.

Copyrights

Certificates

ISO 9001 certification of quality management systems
ISO 14001 certification of environmental management
ISO 45001 certification of health & safety management



A certificate that is a prestigious symbol of success and reliability of a company in the market. Apart from the business premises of your company, this internationally recognized brand of business excellence adorns only 3.6% of companies from the region that have managed to achieve and, which is much more difficult, maintain the highest credit ratings in the last three years.



Selected references

List

Hotels

HOTEL 'GRAND' Kopaonik
HOTEL 'MAMULA ISLAND' Montenegro
HOTEL 'CENTRAL POINT' Belgrade
HOTEL 'SKY' Belgrade
HOTEL 'MONTENEGRO' Bečići
HOTEL 'HYATT' Belgrade
HOTEL 'PUTNIK' Kopaonik
HOTEL 'PODRINJE' Banja Koviljača

Commercial

'SCAVOLINI' STORE Belgrade
'DROBNI PJESAK' Montenegro
'A1' HEADQUARTERS Belgrade
'UŠĆE' FOODCOURT Belgrade
'ION SOLUTIONS' Novi Sad
'EUROBANK' Belgrade and Sombor
'NIS' HEADQUARTERS Novi Sad
'NIS' RESORT Vojvodina

Selected references

Hotels

Hotel Grand

MK Mountain Resort

On Kopaonik, in the most beautiful National Park in Serbia, general contractor Structura Concept has renovated and furnished the Grand Hotel. For a period of seven months, our team of civil, HVAC, electro, and interior engineers have worked together to achieve the goal to the highest standards and hand over the hotel. Special emphasis was placed on the entrance - reception, the Lounge BACCO bar, the Garden restaurant, the Boarding House restaurant, the spa and pool area. Everything had to be perfectly in line with the highest world standards.

STRUCTURA CONCEPT

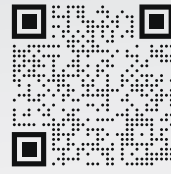

Project task **Reconstruction and furnishing**
Type of building **Hotel**
Project timeline **2021**
Location **Kopaonik, Serbia**
Area **7000 m²**

The sophisticated furniture subtly softens the playfulness and sharpness of the finishing elements, and the result of this combination is an elegant and pleasant space to stay in. The interior is further enriched by plant life. Natural materials dominate, with marble, wood and leather both in the paneling and the furniture. 'Grand' hotel vision has been defined by a seamless alignment of cultural and design sensibilities, modern luxury, art and craftsmanship. A lot of work and effort has been invested to make even the smallest detail perfect, to make an outstanding impression .



MK Mountain Resort

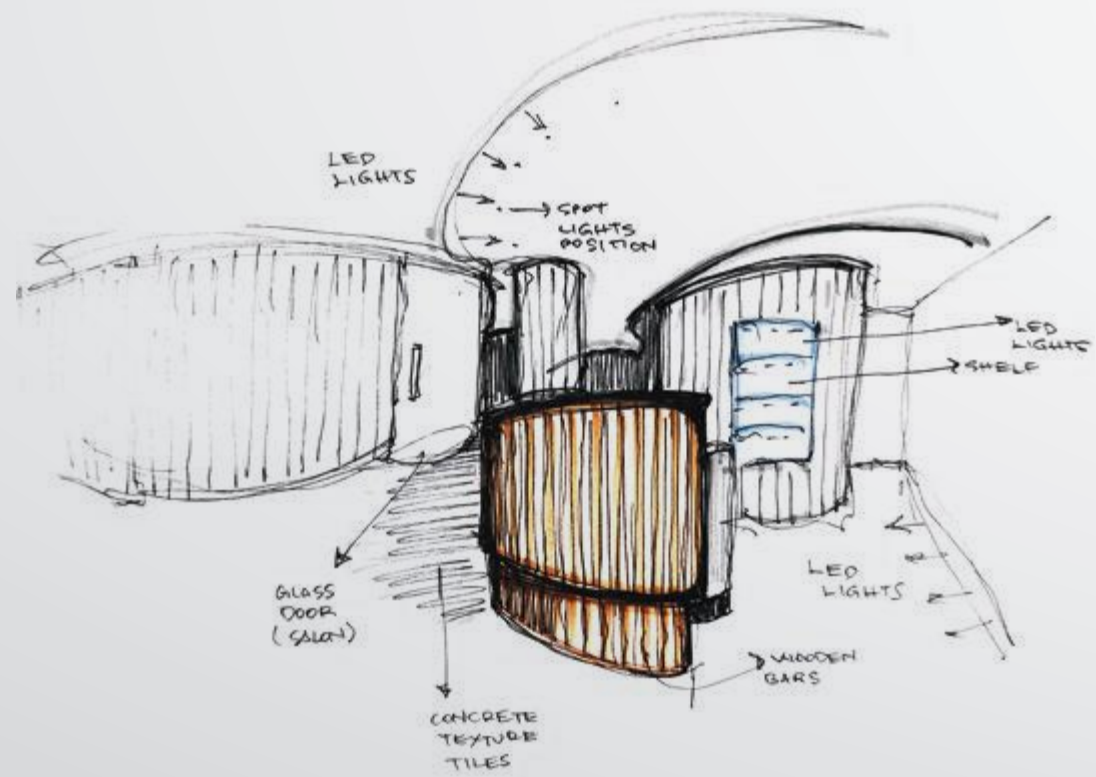
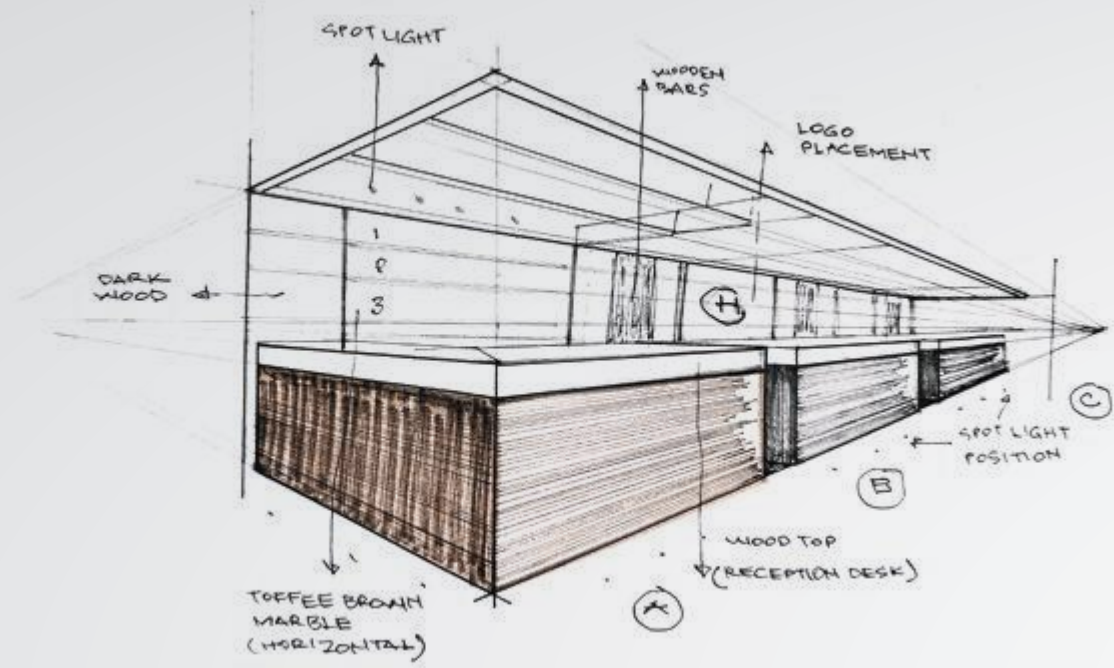

STRUCTURA CONCEPT





Mamula Island

Mamula fortress stands proudly at the entrance to the Bay of Kotor, the embodiment of an extremely bold vision that has given it a more dignified presence now than in the past 80 years of abandonment. The fortress has been restored, preserving its historical and cultural heritage while providing it the profile of the only island spa hotel with a museum. The reconstruction was carried out in accordance with the highest standards, preserving the architectural authenticity and natural heritage of the island.

STRUCTURA CONCEPT

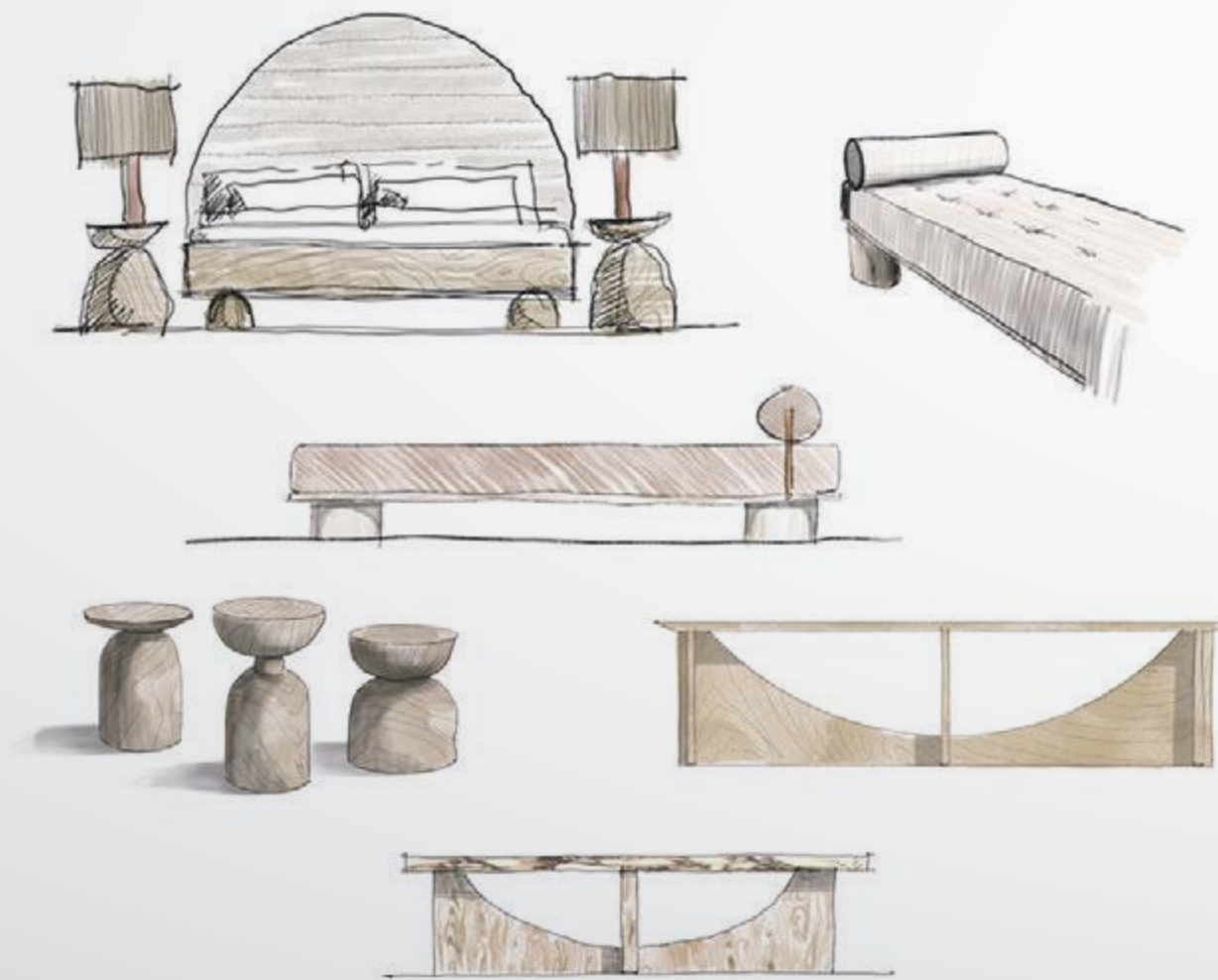

Project task **Furnishing**
Type **Hotel**
Project timeline **2022**
Location **Mamula Island, Montenegro**

Functional schemes and new purposes have been adapted to the geometry of the existing spaces, respecting the atmosphere of the stone walls and vaults. Modest, simple shapes, items of furniture, highlight artisanal details and glorify tradition. The warm shades of oak are present at every step, while the island's paths and passages reveal fresh, infinite views.



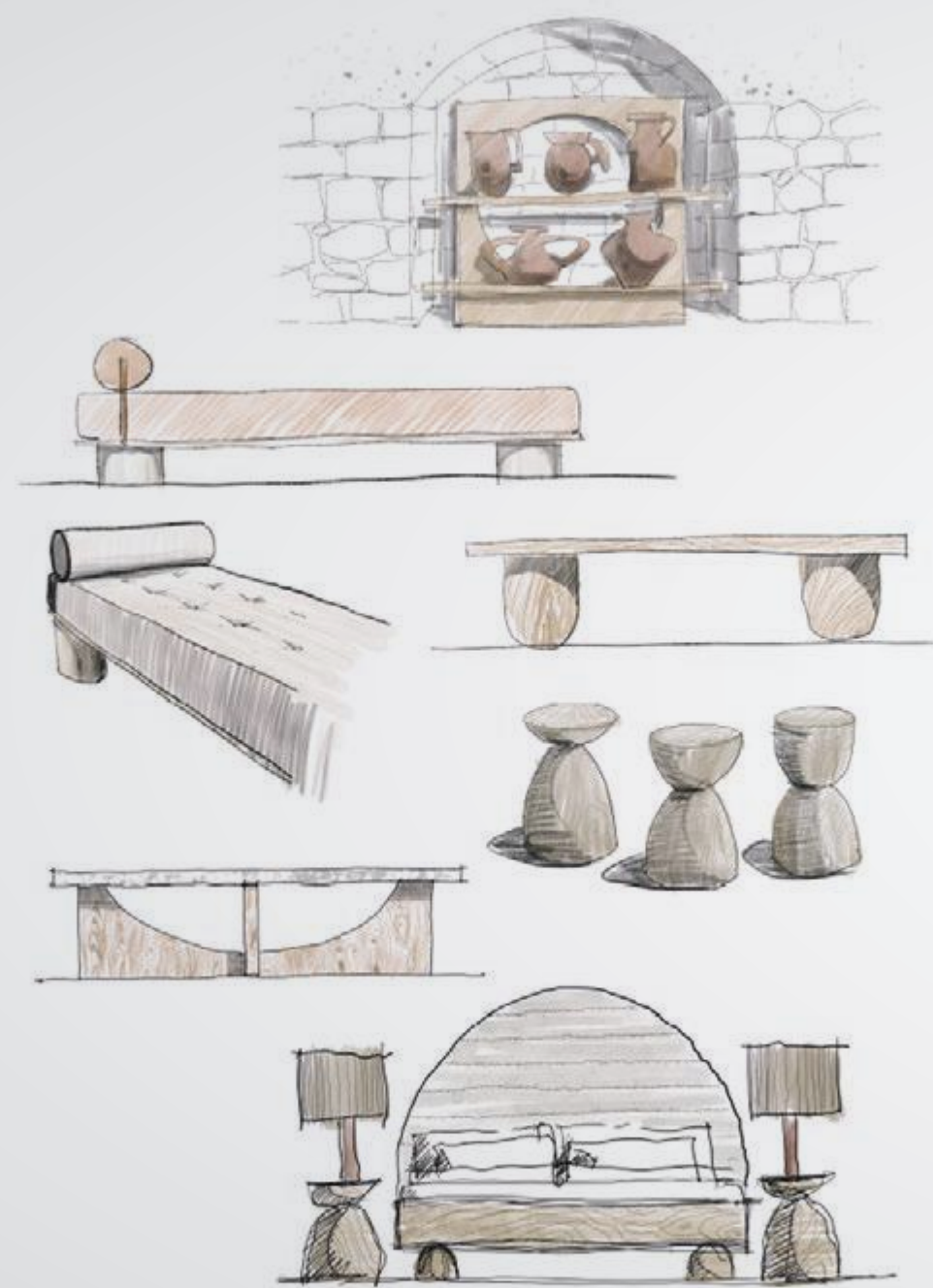

Hotel Central Point

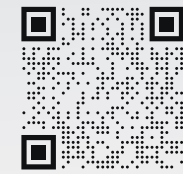

In accordance with the main function of bed & breakfast hotel in the central core of the City of Belgrade, the building consists of 2 underground levels of garages with technical and ancillary rooms, a low ground level that provides vehicle and pedestrian access to the hotel from Takovska Street, with the reception and access features of the commercial part of the building, a mezzanine - gallery with a serving kitchen and restaurant and the business area of the building, with another 6 floors and a recessed floor with 57 accommodation units equipped with the latest, high-quality furniture and fittings, for the comfortable accommodation of hotel guests at a 4-star level. Also extraordinary artistic and aesthetic properties and, on the other hand, the stylistic properties of the existing building – all of these together comprise the basic specific features of this building that one first notices.

STRUCTURA CONCEPT

DFE M.Sc.A. **Jelena Samardžija**

Project Manager M.Sc.C.E. **Danijel Lopatničić**

Project Manager M.Sc.C.E. **Dragan Đinović**



Project task **DFE & Construction**

Type of building **Hotel**

Project timeline **2019/2020**

Location **Belgrade, Serbia**

Area **4200 m²**

The complexity of the function of a hotel, located in the central core of Belgrade, complemented by architectural modelling where the design approach was to connect a modern architectural expression with the use of contemporary materials. It was precisely this - retaining the authenticity of the façades of the existing building, harmonization with the elements that form the volume of the entire facility, and fitting all of it into the existing environment, with the tendency and desire of the author and investor to emphasize its exclusive nature, along with the complex function and location of the building itself.

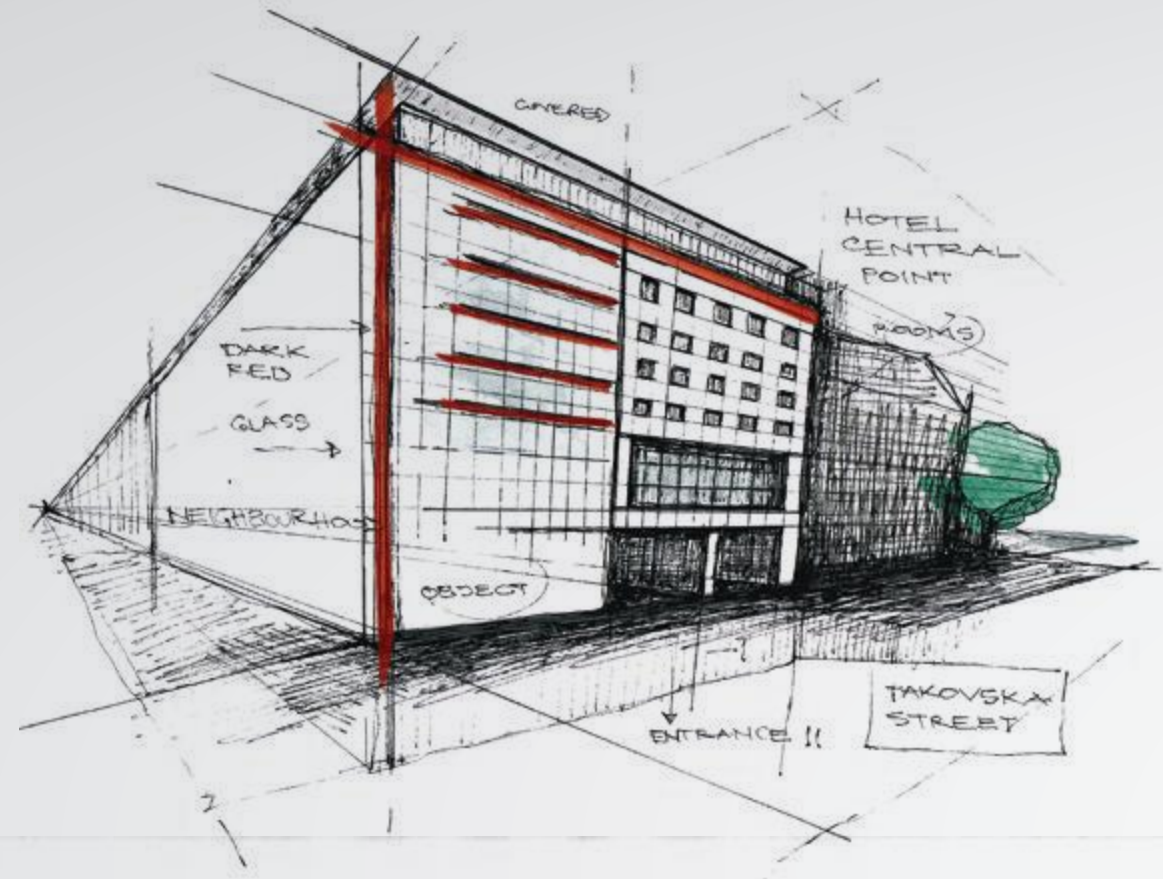

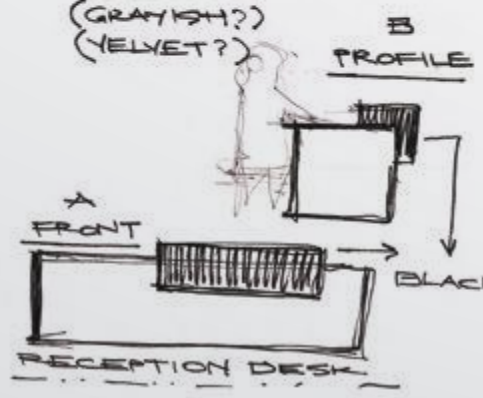
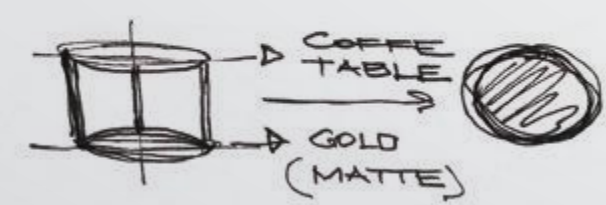
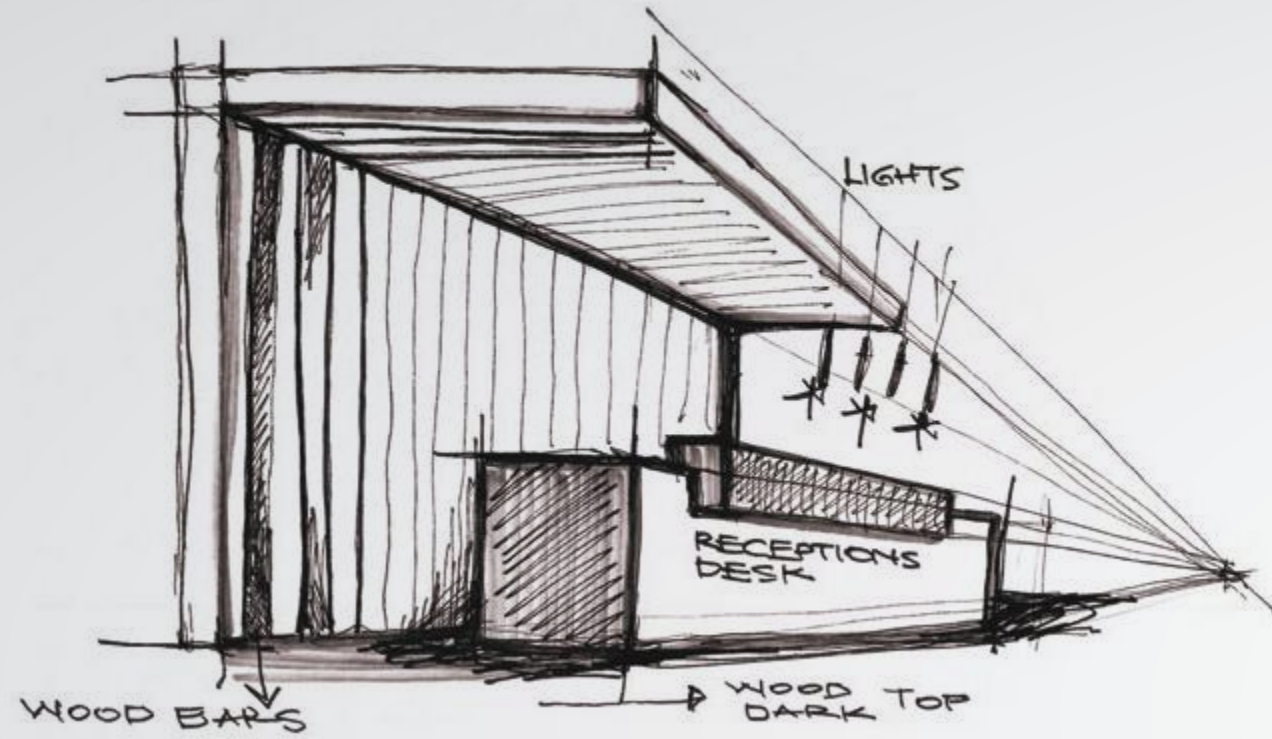

Hotel Sky

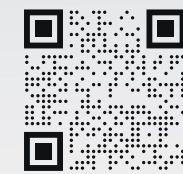

The hotel is located in a peaceful residential zone, not far from the city centre, nestled between traditional urban residential buildings. It consists of five levels, a basement, ground floor and four upper floors. The ground level of the hotel contains the main hall with a reception equipped with modern furniture that, along with the geometric forms permeating the wall, ceiling and floor covers, contributes to the attractiveness and dynamics of this space. The author of the interior of Sky Hotel found inspiration in motifs from nature: the hotel reception was designed as a twisted form, cut through the middle so that the finish of the walls behind it could be glimpsed, and to visually tie together all the elements in this zone.

STRUCTURA CONCEPT



Project task **Design and furnishing**
Type of building **Hotel**
Project timeline **2019**
Location **Belgrade, Serbia**
Area **2000 m²**

The sophisticated furniture subtly softens the playfulness and sharpness of the finishing elements, and the result of this combination is an elegant and pleasant space to stay in. The interior is further enriched by plant life. Natural materials dominate, with marble, wood and leather both in the paneling and the furniture. The services offered by this hotel include a mini-restaurant with breakfast, a conference room and a mini-spa for moments of relaxation.



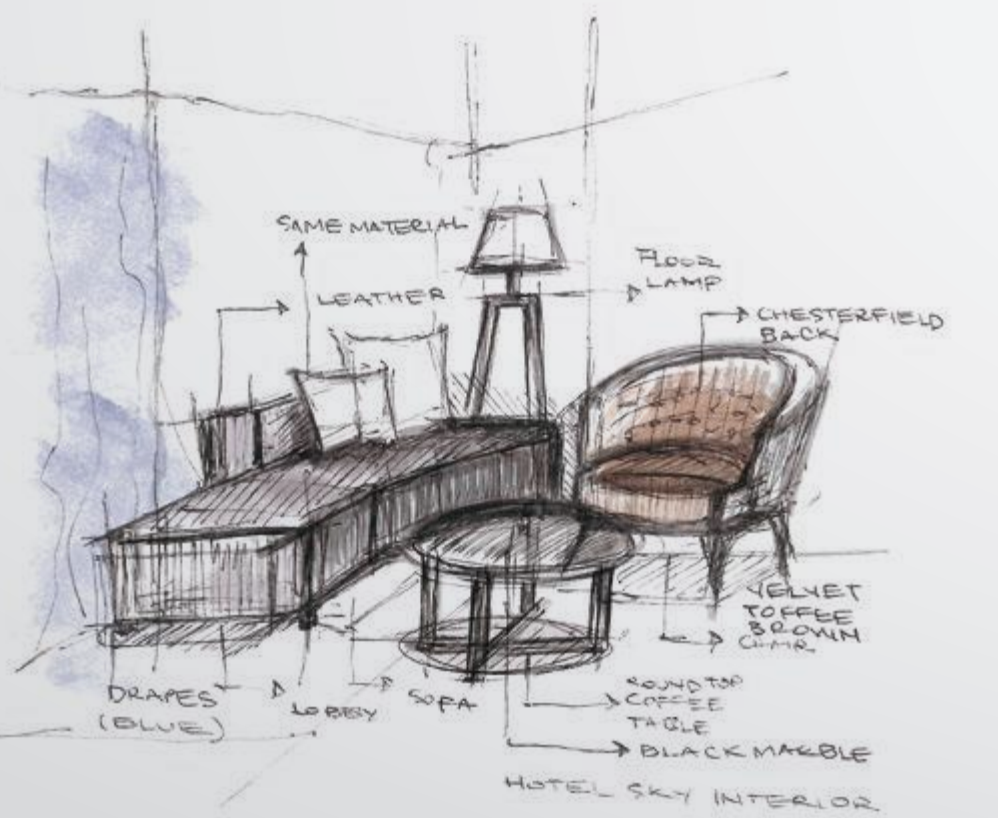
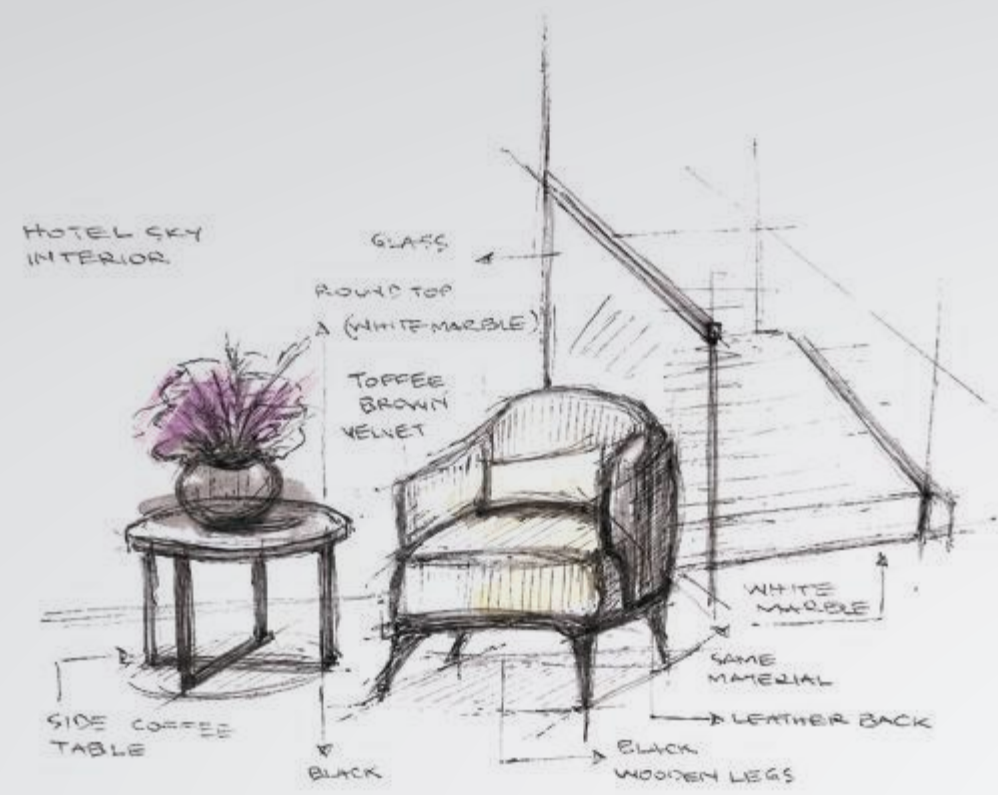

Hotel Montenegro

The hotel lies in a quiet bay at the very beach front, which offers a beautiful view, the very inspiration for the interior design.

The functional solution is planned to meet all the guests' needs and provide the maximum comfort for a restful stay. The subdued interior design with blue tones achieves a direct connection with the view from the hotel room.

The blue colours are reminiscent of the sea, but also provide a calm and relaxing feeling. The careful choice of wallpaper texture, wood paneling and the materials of the furnishings provides a sophisticated atmosphere that makes a direct connection with the coastal mood.

▶ STRUCTURA CONCEPT

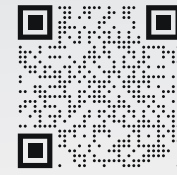

Project task **Design and furnishing**
Type of building **Hotel**
Project timeline **2022**
Location **Bečići, Montenegro**
Area **66 rooms / suites**

Colors inspired by the sun, a texture inspired by sand with details in the color of the sea are the key to creating an atmosphere of Mediterranean style.



Hotel Hyatt

HYATT®

Hyatt Regency Belgrade is hotel for leisure and business travelers, conveniently located in the heart of New Belgrade, the capital's main business and entertainment district, close to the city center and well connected to Belgrade airport.

STRUCTURA CONCEPT

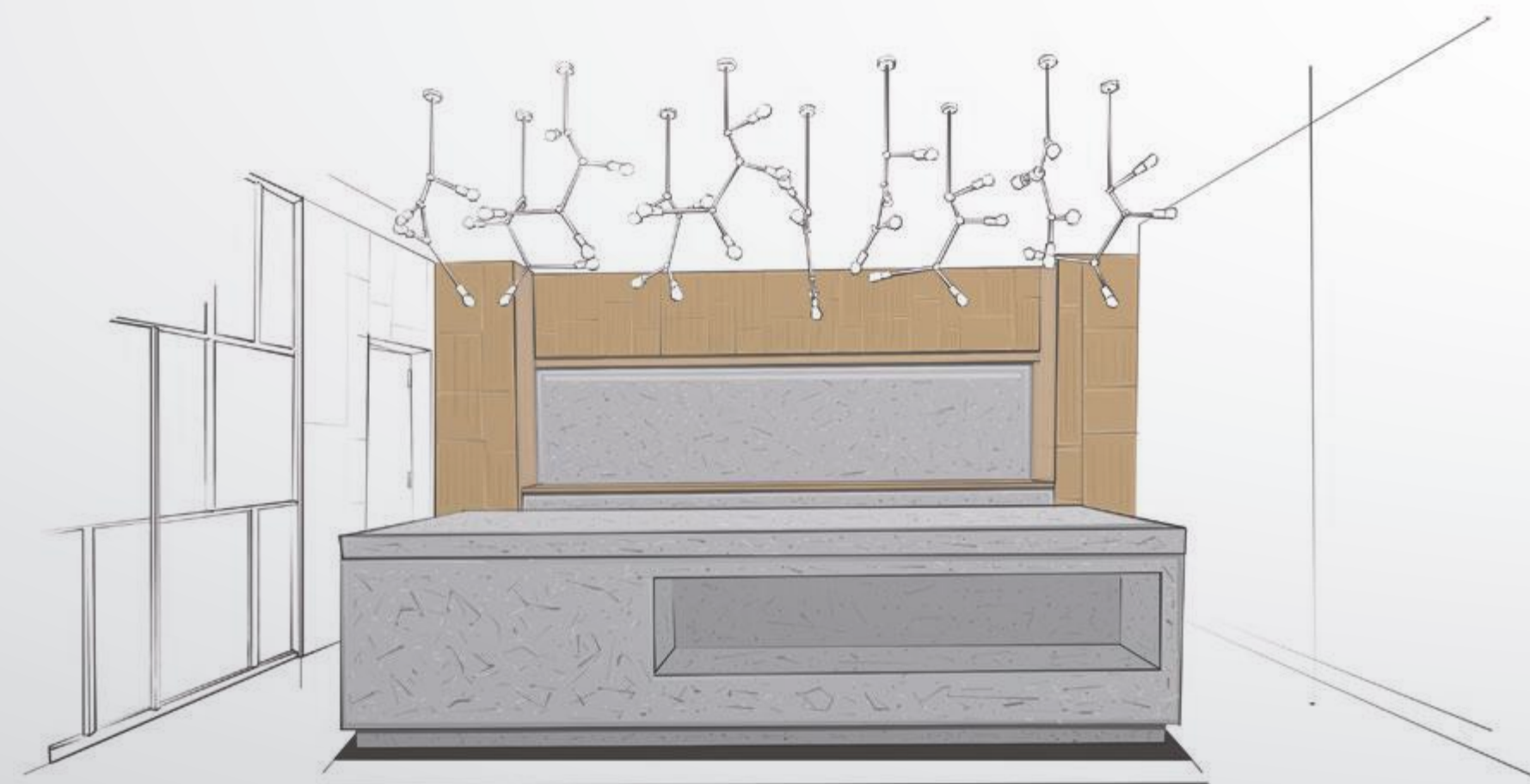
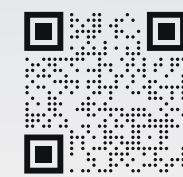

Project task **Reconstruction and furnishing**
Type of building **Hotel**
Project timeline **2019**
Location **Belgrade, Serbia**
Area **437 m²**

We would especially like to highlight works in restaurant 'Focaccia' in the Hyatt such as demolition and dismantling, dry-assembly works (walls and ceilings), prefabricated partitions, stone-cutting works, painting works, floor-laying works, carpentry works, works on plumbing installations, mechanical installations and furnishing. After the reconstruction, the restaurant was named 'Studio'.

HYATT®

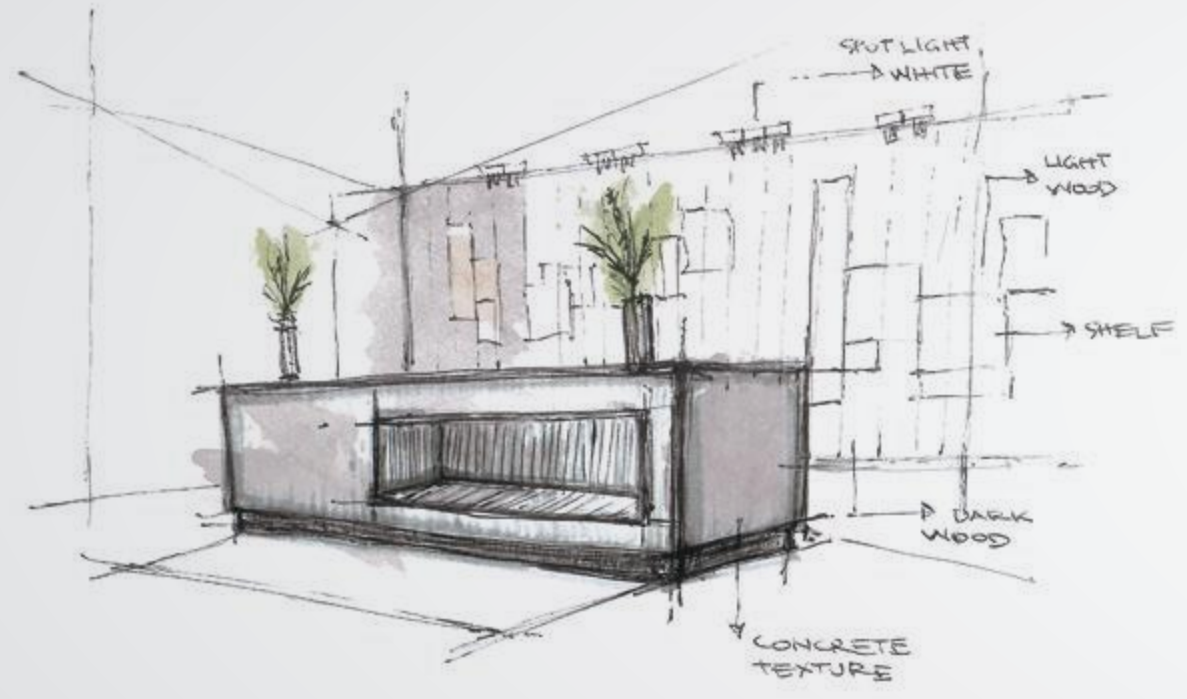

STRUCTURA CONCEPT



HYATT®

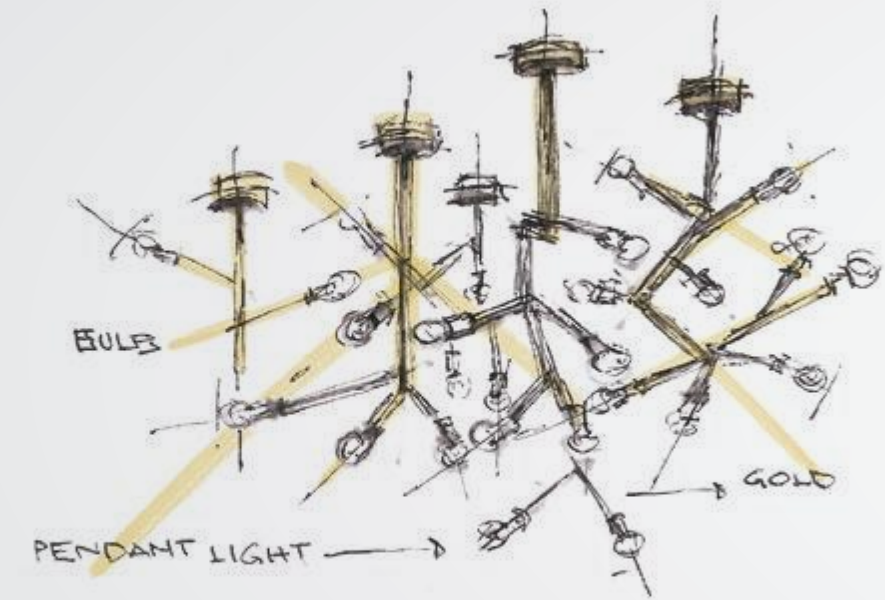

HOTEL HYATT
INTERIOR DETAILS

STRUCTURA CONCEPT



Hotel Putnik

Hotel Putnik lies in the most beautiful part of the Kopaonik mountain in Sunny Valley. It is located at 1,650m above sea level and has direct access to the Sunny Valley ski slope. Structura Concept has furnished 6 VIP luxury apartments for the hotel.

STRUCTURA CONCEPT

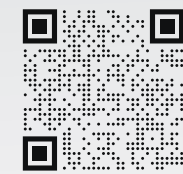

Project task **Furnishing**
Type of building **Hotel**
Project timeline **2019**
Location **Kopaonik, Serbia**

Hotel Podrinje



During its century long existence, the history of „Hotel Podrinje“ was blessed by visits from renown people of their time. King Peter I Karadjordjević, known as the favourite Serbian King among the people, used to arrive by train, reside at nearby Villa Koviljača, strive through the beautiful park and visit Hotel "Podrinje". In memory of the Monarch, near the hotel building stands the SPA bath of King Peter. Nowadays, the park is protected as a natural whole and is in the process of becoming a Park of Nature and Heritage Park that would also include slopes of Mount Gučevo.

The renovated Hotel "Podrinje" will welcome its guests in 43 modern single and double rooms and magnificent apartments located at the first, second, third and attic floor of the building. The guest shall enjoy the indoor pool, summer garden for sunbathing, winter garden with TV lounge, presentation room, children's playroom, room for babies, restaurant and bar.

This future spa gem will also be ideal for treatments in the Special Hospital Banja Koviljača, located only 200 meters away.

The renovation will consist of full fit out works inclusive of newly installed MEP services. Only high range quality finishing materials will be implemented, with high class furniture and up to date hotel equipment. The exterior and interior design will provide luxury while preserving the touch of history. The whole park and the building itself is considered to be a cultural and historical area; cultural Good "Complex SPA Banja Koviljača" that is under the care of the Regional Authority for Protection of Cultural Heritage and Historic Monuments. Once the current reconstruction is done, the spirit of past times will linger within the building by preserving the complete park facing facade of the hotel from 1910, and incorporated with construction of 1979 to 1982 under the design of Architect Mihajlo Mitrović.

► STRUCTURA CONCEPT



Project task **Reconstruction and furnishing**
Type of building **Hotel**
Project timeline **2022/2023**
Location **Banja Koviljača, Serbia**
Area **4.850 m²**

The owner "Estate Glory d.o.o." has appointed "Structura Concept d.o.o." as the General Contractor to undertake the reconstruction works adopting the design done together by the Design Bureaus "Arhitekt Pro" and 'Arhikos'. After the renovation would be completed, the building and the park shall once again embrace within harmony of nature.





Selected references

Commercial

Scavolini store

SCAVOLINI

As we enter the premises of the renowned Italian furniture manufacturer we encounter a sequence of diverse environments one after another. Dark walls, wall covers, tall ceilings, visible pipes and cabling, with carefully selected decorative lighting hanging between them set a background scene that is complemented by the different models of contemporary kitchen. All of this leaves the impression of a design that resembles an arts atelier rather than a classical furniture store. The goal was to maximize the emphasis on each piece of movable furniture, so their materials and shades were carefully chosen and combined.

STRUCTURA CONCEPT

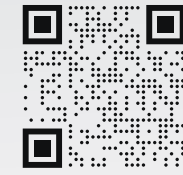
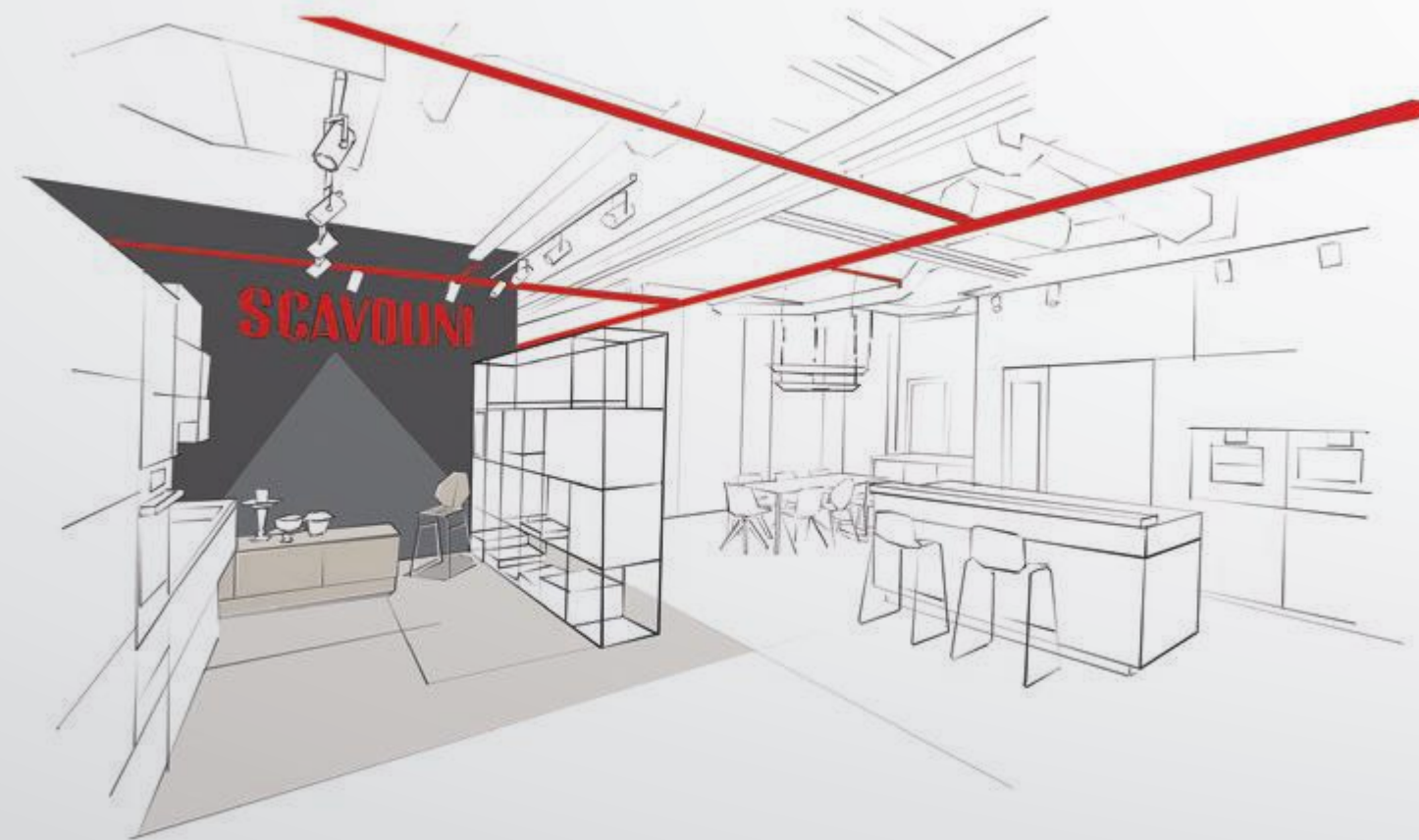

Project task **Design, Reconstruction and furnishing**
Type **Store and offices**
Project timeline **2019**
Location **Belgrade, Serbia**

The sophisticated furniture subtly softens the playfulness and sharpness of the finishing elements, and the result of this combination is an elegant and pleasant space to stay in. The interior is further enriched by plant life. Natural materials dominate, with marble, wood and leather both in the paneling and the furniture. 'Grand' hotel vision has been defined by a seamless alignment of cultural and design sensibilities, modern luxury, art and craftsmanship. A lot of work and effort has been invested to make even the smallest detail perfect, to make an outstanding impression .

SCAVOLINI

Beauty.

Quality.

Shaping





Drobni Pjesak

The refined marine ambience of this complex provides comfort and fun, offers additional facilities, and complements the impression of its guests' summer vacation with a beautiful view of the sea. The idea was for each of the villas to exhibit elegant interior details, their form and finish associative of those used on luxury ships. The combination of modern furniture with fixed, lavish elements - defined through the walls, floors and ceilings - has made the complex of these villas highly recognizable.

▶ STRUCTURA CONCEPT

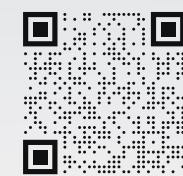

Project task **Design and furnishing**
Type of building **Villas**
Project timeline **2021-2022**
Location **Montenegro**

As for their functionality, each villa consists of four levels, with the first two intended for purposes such as an entertainment room, a mini-bar and living room with a kitchen and dining room, while the other two levels contain relaxation zones: bedrooms and terraces with a view of the garden, the pools of the complex and, of course, the sea.



A1 headquarters

A1

In the centre of Belgrade, Structura Concept has designed and furnished the whole of the administrative building of A1 (the former VIP Mobile). This was an extremely demanding project in a three-storey building in which furniture was made for a staff of 750 including authentic executive offices, meeting rooms, six kitchens and ancillary rooms on each floor.

STRUCTURA CONCEPT

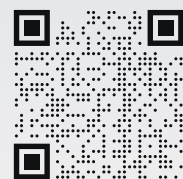

Project task **Design and furnishing**
Type **Headoffice building**
Project timeline **2015**
Location **Belgrade, Serbia**

TC Ušće Food Court

MPC

TC "Ušće" is undoubtedly one of the best-known shopping centres in Serbia. Structura Concept designed and equipped the complete FoodCourt on the top floor of a shopping centre with an area of over 550m2. Characteristic for this work is the combination of standard materials and solid wood, which is our specialty in the design and execution of such projects.

STRUCTURA CONCEPT

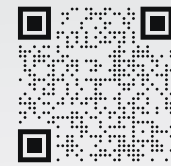

Project task **Design and furnishing**
Type **Food Court**
Project timeline **2015**
Location **Belgrade, Serbia**



ION Solutions



In Novi Sad, Structura Concept furnished the headquarters building of ION Solutions. Furniture was produced for workplaces, meeting rooms, executive offices and auxiliary rooms.

STRUCTURA CONCEPT

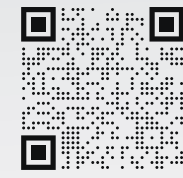

Project task **Furnishing**
Type **Offices**
Project timeline **2015**
Location **Novi Sad, Serbia**

EuroBank



EuroBank is just one of the banking brands for which we worked on furnishings, and on this occasion we would like to single it out due to exceptional cooperation over several years. We would especially like to mention the branches in Belgrade, Sombor and Novi Sad. Extremely demanding desks, staff workplaces, meeting rooms, executive offices and ancillary rooms were made in all branches.

► STRUCTURA CONCEPT

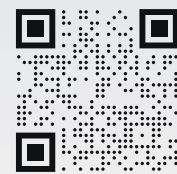

Project task **Furnishing**
Type of building **Bank**
Project timeline **2017-2019**
Location **Belgrade, Novi Sad and Sombor**

SARADNIK ZA POSLOVE
SA STANOVNIŠTVOM

5

Rešenja kreirana
baš za mene

Briga o klijentima

Pouzdanost

Zato što vrhunski
stručnjak sve ume
da objasni i reši na
jednostavan način.

Inovativnost

Jednostavno moja

Kvalitet usluge

Odgovornost

Zato što je moje sve
ono što razumem,
čemu verujem i što
formira moj život.

**Stručnost u
službi klijena**

Društvena odgovornost

Fokus na klijenta

Inovacije i inspiracija

Professionalizacija



NIS headquarters



In the imposing building of the NIS headquarters in Novi Sad, Structura Concept designed and furnished two floors. This project certainly highlights the executive offices that are made using the highest quality materials in combination with solid wood. They would also like to point out the staff offices, meeting rooms and ancillary rooms.

STRUCTURA CONCEPT

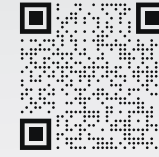

Project task **Design and furnishing**
Type **Headoffice building**
Project timeline **2015**
Location **Novi Sad, Serbia**



NIS Resort



In a beautiful spot in the heart of the Vojvodina plain, Structura Concept designed and furnished the NIS Resort. This beautiful resort covers two floors. On the ground floor there are representative lounges and meeting rooms, and on the upper floor there are guest rooms designed and fully equipped by Structura Concept.



▶ STRUCTURA CONCEPT



Project task **Design and furnishing**
Type **Resort**
Project timeline **2014**
Location **Vojvodina, Serbia**



Our respectful

Clients





www.structuraconcept.com
office@structuraconcept.com

BELGRADE

Južni bulevar 84/23

NOVI SAD

Cara Dušana 32

SKOPJE

Blvd. Partizanski Odredi 15A/1-11

ZAGREB

Kneza Mislava 14

